

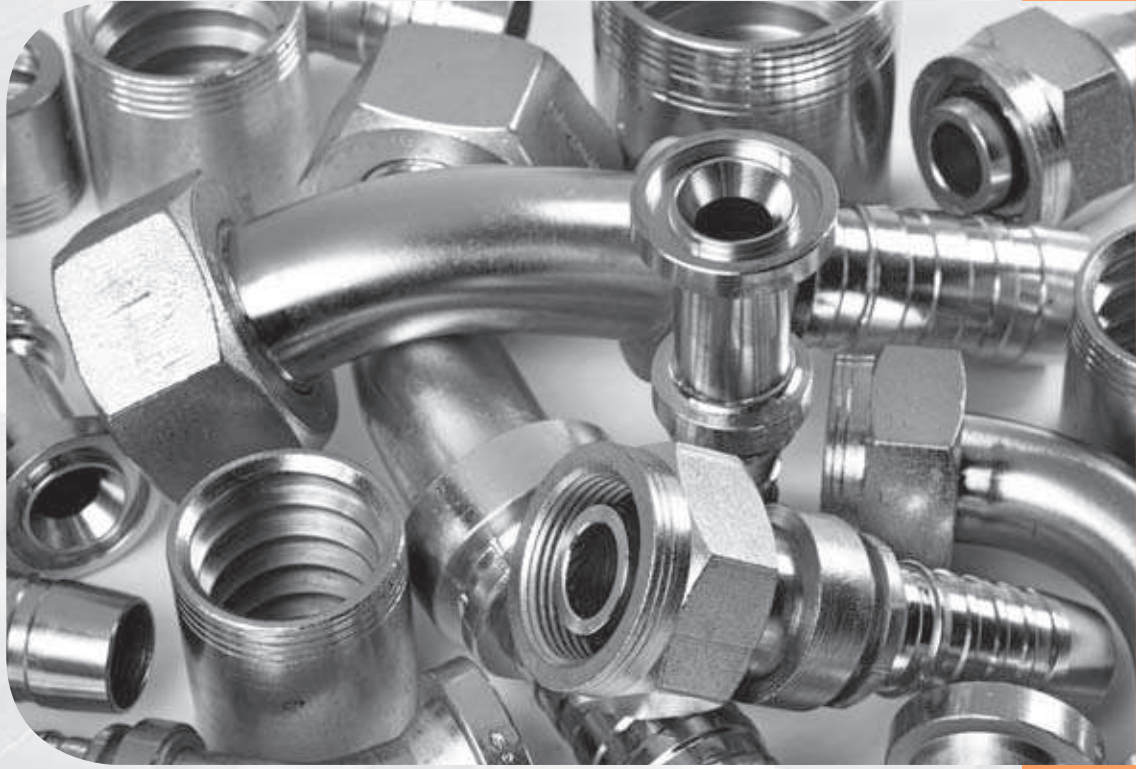

HİDROLİK HORTUMLAR, KAPLİNLER & EKİPMANLAR

KAPLİN DÜNYASI

GlobalSpiral™



SOYMASIZ TIP SOKETLER

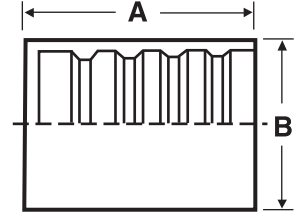

↔			↔		
D			A	B	REF.
-ölçü	DN	"	mm	mm	GS
-6	10	3/8	36,3	31,8	6GS1F-4
-8	12	1/2	36,6	34,4	8GS1F-4
-10	16	5/8	47,8	41,7	10GS1F-4
-12	20	3/4	50,0	45,7	12GS1F-4
-16	25	1	56,4	52,6	16GS1F-4
-20	32	1 1/4	67,8	61,5	20GS1F-4
-20	32	1 1/4	72,9	67,8	20GS1F-6
-24	40	1 1/2	76,5	72,0	24GSP1F-4
-32	50	2	91,0	85,0	32GSP1F-4

Not: 4 kat spiral telli hortum için GSP1F-4 soket kullanın. 6 kat spiral telli hortum için 1-parçalık GSH-kaplin kullanın.

Aksi belirtilmedikçe Kaplin, ilgili uluslararası standardın basınç ölçüm gereksinimlerini karşılar.

BSP FBSPORX

Dişi BSP'O' ringli döner somunlu. 60° konik.

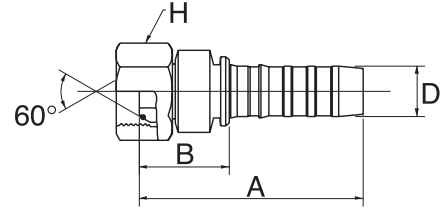

D			A B H			REF.	
-ölçü	DN	"	mm	mm	mm	GS	
-6	10	3/8	G 3/8" - 19 BSP	60,5	24,7	22,0	6GS6FBSPORX
-6	10	3/8	G 1/2" - 14 BSP	60,2	24,4	27,0	6GS8FBSPORX
-8	12	1/2	G 1/2" - 14 BSP	61,0	23,5	27,0	8GS8FBSPORX
-8	12	1/2	G 5/8" - 14 BSP	62,0	24,5	30,0	8GS10FBSPORX
-10	16	5/8	G 5/8" - 14 BSP	80,5	30,2	30,0	10GS10FBSPORX
-10	16	5/8	G 3/4" - 14 BSP	82,3	32,0	32,0	10GS12FBSPORX
-12	20	3/4	G 3/4" - 14 BSP	86,5	35,5	32,0	12GS12FBSPORX
-12	20	3/4	G 1" - 11 BSP	86,6	35,6	41,0	12GS16FBSPORX
-16	25	1	G 1" - 11 BSP	95,0	38,6	41,0	16GS16FBSPORX
-16	25	1	G 1 1/4" - 11 BSP	83,0	26,2	50,0	16GS20FBSPORX
-20	32	1 1/4	G 1 1/4" - 11 BSP	116,5	45,4	50,0	20GS20FBSPORX
-24	40	1 1/2	G 1 1/2" - 11 BSP	154,0	58,8	55,0	24GSH24FBSPORX
-24	40	1 1/2	G 1 1/2" - 11 BSP	125,0	51,3	55,0	24GSP24FBSPORX
-32	50	2	G 2" - 11 BSP	184,0	69,9	70,0	32GSH32FBSPORX
-32	50	2	G 2" - 11 BSP	152,0	60,0	70,0	32GSP32FBSPORX

-6 ila -20 ölçüsü 42,0 MPa'dır (6000 psi); -24GSH 35,0 MPa'dır (5000 psi); -32GSH 28,0 MPa'dır (4000 psi).

BSP FBSPORX45

Dişi BSP'O' ringli döner somunlu.

60° konik. 45° dirsek.

Boyun uzunluğu ISO 12151-6'yı karşılar.

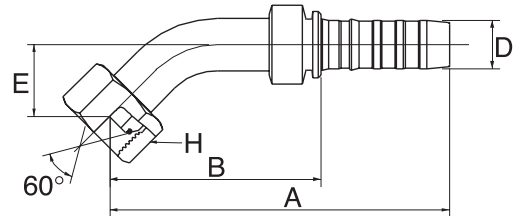

D			A B E H				REF.	
-ölçü	DN	"	mm	mm	mm	mm	GS	
-6	10	3/8	G 3/8" - 19 BSP	83,1	47,3	15,4	22,0	6GS6FBSPORX45
-8	12	1/2	G 1/2" - 14 BSP	91,5	54,1	17,0	27,0	8GS8FBSPORX45
-10	16	5/8	G 5/8" - 14 BSP	118,0	67,7	21,3	30,0	10GS10FBSPORX45
-10	16	5/8	G 3/4" - 14 BSP	127,9	77,6	31,2	32,0	10GS12FBSPORX45
-12	20	3/4	G 3/4" - 14 BSP	132,6	81,6	28,3	32,0	12GS12FBSPORX45
-16	25	1	G 1" - 11 BSP	155,5	99,1	30,9	41,0	16GS16FBSPORX45
-20	32	1 1/4	G 1 1/4" - 11 BSP	191,1	119,9	37,5	50,0	20GS20FBSPORX45
-24	40	1 1/2	G 1 1/2" - 11 BSP	242,5	147,5	49,7	55,0	24GSH24FBSPORX45
-24	40	1 1/2	G 1 1/2" - 11 BSP	214,5	140,8	49,7	55,0	24GSP24FBSPORX45
-32	50	2	G 2" - 11 BSP	276,1	184,1	62,3	70,0	32GSP32FBSPORX45

-6 ila -20 ölçüleri 42,0 MPa'dır (6000 psi); -24GSH 35,0 MPa'dır (5000 psi).

Aksi belirtilmedikçe Kaplin, ilgili uluslararası standardın basınç ölçüm gereksinimlerini karşılar.

BSP FBSPORX90

Dişi BSP 'O' ringli döner somunlu.
60° konik. 90° dirsek.
Boyun uzunluğu ISO 12151-6'ya karşılar.

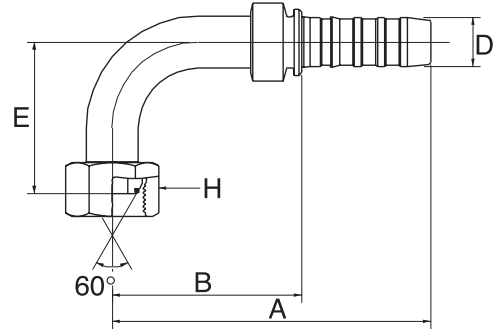

↔			🌀	↔				🌀
D				A	B	E	H	REF.
-ölçü	DN	"		mm	mm	mm	mm	GS
-6	10	3/8	G 3/8" - 19 BSP	78,0	42,2	32,0	22,0	6GS6FBSPORX90
-8	12	1/2	G 1/2" - 14 BSP	88,0	50,5	37,5	27,0	8GS8FBSPORX90
-10	16	5/8	G 5/8" - 14 BSP	112,5	62,2	46,0	30,0	10GS10FBSPORX90
-10	16	5/8	G 3/4" - 14 BSP	112,5	62,2	60,0	32,0	10GS12FBSPORX90
-12	20	3/4	G 3/4" - 14 BSP	124,2	73,2	60,0	32,0	12GS12FBSPORX90
-16	25	1	G 1" - 11 BSP	151,0	94,6	70,0	41,0	16GS16FBSPORX90
-20	32	1 1/4	G 1 1/4" - 11 BSP	180,5	109,4	80,0	50,0	20GS20FBSPORX90
-24	40	1 1/2	G 1 1/2" - 11 BSP	222,6	127,6	100,0	55,0	24GSH24FBSPORX90
-24	40	1 1/2	G 1 1/2" - 11 BSP	194,6	120,9	100,0	55,0	24GSP24FBSPORX90
-32	50	2	G 2" - 11 BSP	254,7	162,7	129,1	70,0	32GSP32FBSPORX90

-6 ila -20 ölçüleri 42,0 MPa'dır (6000 psi); -24GSH 35,0 MPa'dır (5000 psi).

BSP MBSPP

Erkek BSP paralel. 60° ters konik.

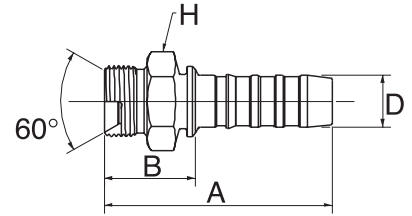

↔			🌀	↔			🌀
D				A	B	H	REF.
-ölçü	DN	"		mm	mm	mm	GS
-6	10	3/8	G 3/8" - 19 BSP	63,0	27,2	22,0	6GS6MBSPP
-6	10	3/8	G 1/2" - 14 BSP	68,0	32,2	27,0	6GS8MBSPP
-8	12	1/2	G 1/2" - 14 BSP	67,5	30,0	27,0	8GS8MBSPP
-10	16	5/8	G 5/8" - 14 BSP	84,0	33,7	30,0	10GS10MBSPP
-10	16	5/8	G 3/4" - 14 BSP	85,0	34,7	32,0	10GS12MBSPP
-12	20	3/4	G 3/4" - 14 BSP	85,0	34,7	32,0	12GS12MBSPP
-12	20	3/4	G 1" - 11 BSP	90,0	39,0	41,0	12GS16MBSPP
-16	25	1	G 1" - 11 BSP	98,0	41,2	41,0	16GS16MBSPP
-20	32	1 1/4	G 1 1/4" - 11 BSP	118,0	46,9	50,0	20GS20MBSPP
-24	40	1 1/2	G 1 1/2" - 11 BSP	163,0	68,0	55,0	24GSH24MBSPP
-24	40	1 1/2	G 1 1/2" - 11 BSP	130,0	56,4	55,0	24GSP24MBSPP
-32	50	2	G 2" - 11 BSP	188,0	74,0	70,0	32GSH32MBSPP
-32	50	2	G 2" - 11 BSP	148,8	56,8	70,0	32GSP32MBSPP

-6 ila -20 ölçüleri 42,0 MPa'dır (6000 psi).

Aksi belirtilmedikçe Kaplin, ilgili uluslararası standardın basınç ölçüm gereksinimlerini karşılar.

JIC 37° FJX

Dişi JIC döner somunlu. 37° ters konik.

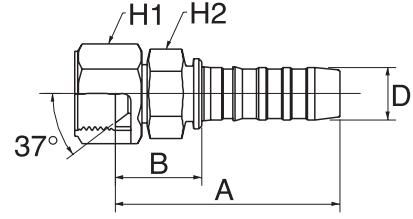

↻			🌀	↔	🌀			🌀
D				A	B	H1	H2	REF.
-ölçü	DN	"		mm	mm	mm	mm	GS
-6	10	3/8	9/16" - 18 UNF	69,0	33,0	19,1	19,1	6GS6FJX
-6	10	3/8	3/4" - 16 UNF	71,0	35,2	22,2	19,1	6GS8FJX
-8	12	1/2	3/4" - 16 UNF	72,0	34,5	22,2	22,2	8GS8FJX
-8	12	1/2	7/8" - 14 UNF	75,9	38,4	27,0	22,2	8GS10FJX
-8	12	1/2	1 1/16" - 12 UN	77,0	39,5	31,8	22,2	8GS12FJX
-10	16	5/8	7/8" - 14 UNF	93,5	43,2	27,0	25,4	10GS10FJX
-10	16	5/8	1 1/16" - 12 UN	95,0	44,7	31,8	25,4	10GS12FJX
-12	20	3/4	7/8" - 14 UNF	98,4	47,4	28,6	27,0	12GS10FJX
-12	20	3/4	1 1/16" - 12 UN	98,0	47,0	31,8	28,6	12GS12FJX
-12	20	3/4	1 3/16" - 12 UN	103,2	52,2	34,9	28,6	12GS14FJX
-12	20	3/4	1 5/16" - 12 UN	102,0	51,0	38,1	28,6	12GS16FJX
-16	25	1	1 1/16" - 12 UN	107,5	50,7	34,9	34,9	16GS12FJX
-16	25	1	1 3/16" - 12 UN	107,9	51,1	38,1	34,9	16GS14FJX
-16	25	1	1 5/16" - 12 UN	109,6	53,3	38,1	38,1	16GS16FJX
-16	25	1	1 5/8" - 12 UN	115,0	58,6	50,8	38,1	16GS20FJX
-20	32	1 1/4	1 5/16" - 12 UN	129,0	57,9	41,3	44,5	20GS16FJX
-20	32	1 1/4	1 5/8" - 12 UN	136,0	64,9	50,8	47,6	20GS20FJX
-20	32	1 1/4	1 7/8" - 12 UN	137,0	65,9	60,3	47,6	20GS24FJX
-24	40	1 1/2	1 7/8" - 12 UN	152,9	57,9	60,0	55,0	24GSH24FJX
-24	40	1 1/2	1 7/8" - 12 UN	124,0	50,4	60,0	55,0	24GSP24FJX
-32	50	2	2 1/2" - 12 UN	180,0	66,0	75,0	70,0	32GSH32FJX
-32	50	2	2 1/2" - 12 UN	148,0	56,0	75,0	65,0	32GSP32FJX

-6 ila -20 ölçüleri 42,0 MPa'dır (6000 psi).

Aksi belirtilmedikçe Kaplin, ilgili uluslararası standardın basınç ölçüm gereksinimlerini karşılar.

JIC 37° FJX45S

Dişi JIC döner somunlu. 37° ters konik. 45° dirsek. Kısa boyunlu (-6 ila -20 Boyun uzunluğu ISO 12151-5'i karşılar).

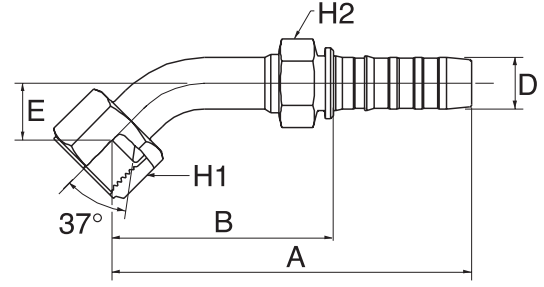

D			A			B			E			H1			H2			REF.		
-ölçü	DN	"	mm	mm	mm	mm	mm	mm	mm	mm	mm	mm	mm	mm	mm	mm	mm	mm	mm	GS
-6	10	3/8	9/16" - 18 UNF	82,0	46,2	11,0	19,1	19,1	6GS6FJX45S											
-6	10	3/8	3/4" - 16 UNF	93,0	57,2	15,0	22,2	19,1	6GS8FJX45S											
-8	12	1/2	3/4" - 16 UNF	94,0	56,5	15,0	22,2	22,2	8GS8FJX45S											
-8	12	1/2	7/8" - 14 UNF	91,0	53,5	16,0	27,0	22,2	8GS10FJX45S											
-10	16	5/8	7/8" - 14 UNF	113,0	63,0	18,0	27,0	30,0	10GS10FJX45-018											
-10	16	5/8	1 1/16" - 12 UN	122,0	71,7	21,0	31,8	25,4	10GS12FJX45S											
-12	20	3/4	1 1/16" - 12 UN	130,0	79,0	21,0	31,8	28,6	12GS12FJX45S											
-12	20	3/4	1 5/16" - 12 UN	137,0	86,0	24,0	38,1	28,6	12GS16FJX45S											
-16	25	1	1 5/16" - 12 UN	152,0	95,7	24,0	38,1	38,1	16GS16FJX45S											
-16	25	1	1 5/8" - 12 UN	164,0	107,7	25,0	50,8	38,1	16GS20FJX45S											
-20	32	1 1/4	1 5/8" - 12 UN	180,0	109,0	38,0	50,8	47,6	20GS20FJX45S											
-24	40	1 1/2	1 7/8" - 12 UN	226,1	130,9	34,0	60,0	55,0	24GSH24FJX45M											
-24	40	1 1/2	1 7/8" - 12 UN	233,0	159,5	50,0	60,0	55,0	24GSP24FJX45-050											
-32	50	2	2 1/2" - 12 UN	276,0	183,8	45,0	75,0	65,0	32GSP32FJX45-065											

-6 ila -20 ölçüleri 42,0 MPa'dır (6000 psi). / M: Orta boyunlu.

JIC 37° FJX90S

Dişi JIC döner somunlu. 37° ters konik. 90° dirsek. Kısa boyunlu (-6 ila -20 Boyun uzunluğu ISO 12151-5'i karşılar).

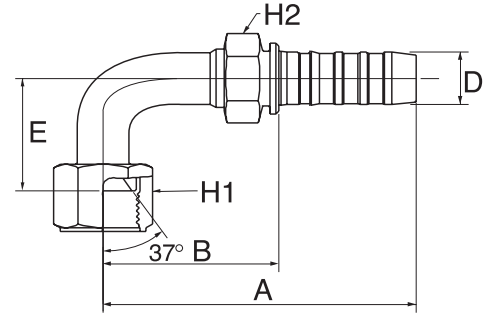

D			A			B			E			H1			H2			REF.		
-ölçü	DN	"	mm	mm	mm	mm	mm	mm	mm	mm	mm	mm	mm	mm	mm	mm	mm	mm	mm	GS
-6	10	3/8	9/16" - 18 UNF	79,0	43,2	23,0	19,1	19,1	6GS6FJX90S											
-8	12	1/2	3/4" - 16 UNF	86,0	48,6	29,0	22,2	22,2	8GS8FJX90S											
-8	12	1/2	7/8" - 14 UNF	92,0	54,5	32,0	27,0	22,2	8GS10FJX90S											
-8	12	1/2	1 1/16" - 12 UN	111,0	73,5	48,0	31,8	22,2	8GS12FJX90S											
-10	16	5/8	7/8" - 14 UNF	111,0	43,3	36,0	27,0	30,0	10GS10FJX90-036											
-12	20	3/4	1 1/16" - 12 UN	119,0	68,0	48,0	31,8	28,6	12GS12FJX90S											
-12	20	3/4	1 5/16" - 12 UN	135,0	84,0	56,0	38,1	28,6	12GS16FJX90S											
-16	25	1	1 5/16" - 12 UN	144,0	87,6	56,0	38,1	38,1	16GS16FJX90S											
-20	32	1 1/4	1 5/8" - 12 UN	174,0	102,9	64,0	50,8	47,6	20GS20FJX90S											

-6 ila -20 ölçüleri 42,0 MPa'dır (6000 psi).

Aksi belirtilmedikçe Kaplin, ilgili uluslararası standardın basınç ölçüm gereksinimlerini karşılar.

JIC 37° FJX90M

Dişi JIC döner somunlu. 37° ters konik. 90° dirsek.
Orta boyunlu (-6 ila -20 Boyun uzunluğu
ISO 12151-5'i karşılar).

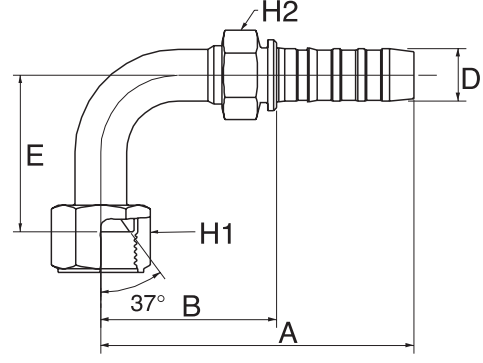

↔			🌀	↔					🌀
D				A	B	E	H1	H2	REF.
-ölçü	DN	"		mm	mm	mm	mm	mm	GS
-6	10	3/8	3/4" - 16 UNF	91,0	55,2	41,0	22,2	19,1	6GS8FJX90M
-8	12	1/2	3/4" - 16 UNF	92,0	54,6	41,0	22,2	22,2	8GS8FJX90M
-8	12	1/2	7/8" - 14 UNF	89,0	51,5	47,0	27,0	22,2	8GS10FJX90M
-10	16	5/8	7/8" - 14 UNF	107,0	56,7	47,0	27,0	25,4	10GS10FJX90M
-10	16	5/8	1 1/16" - 12 UN	121,0	70,7	58,0	31,8	25,4	10GS12FJX90M
-12	20	3/4	1 1/16" - 12 UN	119,0	68,0	58,0	31,8	28,6	12GS12FJX90M
-12	20	3/4	1 3/16" - 12 UN	141,0	90,0	60,0	34,9	28,6	12GS14FJX90-060
-12	20	3/4	1 5/16" - 12 UN	135,0	84,0	71,0	38,1	28,6	12GS16FJX90M
-16	25	1	1 5/16" - 12 UN	144,0	87,6	71,0	38,1	38,1	16GS16FJX90M
-20	32	1 1/4	1 5/8" - 12 UN	174,0	102,9	78,0	50,8	47,6	20GS20FJX90M
-24	40	1 1/2	1 7/8" - 12 UN	227,5	132,3	86,0	60,0	55,0	24GSH24FJX90M
-24	40	1 1/2	1 7/8" - 12 UN	212,0	138,4	89,0	60,0	55,0	24GSP24FJX90-089
-32	50	2	2 1/2" - 12 UN	272,0	179,7	140,0	75,0	65,0	32GSP32FJX90

-6 ila -20 ölçüleri 42,0 MPa'dır (6000 psi).

Aksi belirtilmedikçe Kaplin, ilgili uluslararası standardın basınç ölçüm gereksinimlerini karşılar.

JIC 37° FJX90L

Dişi JIC döner somunlu. 37° ters konik. 90° dirsek.
Uzun boyunlu (-6 ila -20 Boyun uzunluğu
ISO 12151-5'i karşılar).

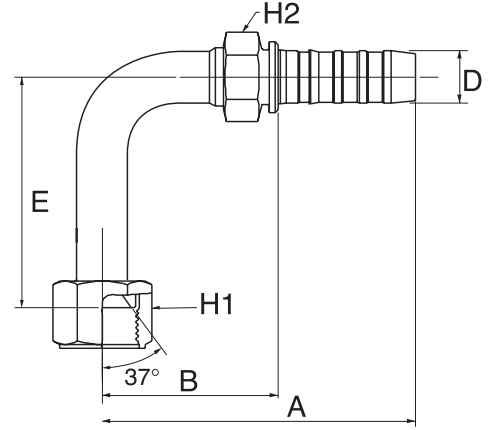

D				A	B	E	H1	H2	REF.
-ölçü	DN	"		mm	mm	mm	mm	mm	GS
-6	10	3/8	9/16" - 18 UNF	86,0	50,2	54,0	19,1	19,1	6GS6FJX90L
-8	12	1/2	3/4" - 16 UNF	92,0	54,6	64,0	22,2	22,2	8GS8FJX90L
-8	12	1/2	7/8" - 14 UNF	89,0	51,5	70,0	27,0	22,2	8GS10FJX90L
-12	20	3/4	1 1/16" - 12 UN	113,0	62,0	96,0	31,8	28,6	12GS12FJX90L
-16	25	1	1 5/16" - 12 UN	144,0	87,6	114,0	38,1	38,1	16GS16FJX90L
-16	25	1	1 5/8" - 12 UN	154,0	97,6	129,0	50,8	38,1	16GS20FJX90L
-20	32	1 1/4	1 5/8" - 12 UN	174,0	102,9	129,0	50,8	47,6	20GS20FJX90L

-6 ila -20 ölçüleri 42,0 MPa'dır (6000 psi).

JIC 37° MJ

Erkek JIC paralel. 37° konik.

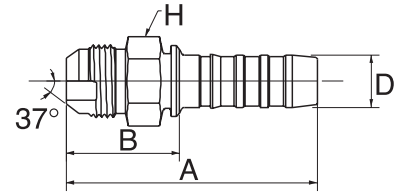

D				A	B	H	REF.
-ölçü	DN	"		mm	mm	mm	GS
-6	10	3/8	9/16" - 18 UNF	66,0	30,2	17,5	6GS6MJ
-6	10	3/8	3/4" - 16 UNF	70,0	34,2	20,6	6GS8MJ
-6	10	3/8	7/8" - 14 UNF	77,0	41,2	23,8	6GS10MJ
-8	12	1/2	3/4" - 16 UNF	72,0	34,5	20,6	8GS8MJ
-8	12	1/2	7/8" - 14 UNF	75,0	37,5	22,2	8GS10MJ
-10	16	5/8	7/8" - 14 UNF	92,0	41,7	23,8	10GS10MJ
-10	16	5/8	1 1/16" - 12 UN	94,0	43,7	27,0	10GS12MJ
-12	20	3/4	1 1/16" - 12 UN	93,0	42,0	28,6	12GS12MJ
-12	20	3/4	1 3/16" - 12 UN	94,0	43,0	31,8	12GS14MJ
-12	20	3/4	1 5/16" - 12 UN	96,0	45,0	33,3	12GS16MJ
-16	25	1	1 5/16" - 12 UN	104,0	47,2	34,9	16GS16MJ
-16	25	1	1 5/8" - 12 UN	108,5	51,7	44,5	16GS20MJ
-20	32	1 1/4	1 5/8" - 12 UN	125,0	53,9	44,5	20GS20MJ
-24	40	1 1/2	1 7/8" - 12 UN	162,3	87,3	50,0	24GSH24MJ
-24	40	1 1/2	1 7/8" - 12 UN	130,0	56,4	50,0	24GSP24MJ
-32	50	2	2 1/2" - 12 UN	196,2	82,2	65,0	32GSH32MJ
-32	50	2	2 1/2" - 12 UN	161,1	69,1	65,0	32GSP32MJ

-6 ila -20 ölçüleri 42,0 MPa'dır (6000 psi).

Aksi belirtilmedikçe Kaplin, ilgili uluslararası standardın basınç ölçüm gereksinimlerini karşılar.

JIS FKX

Dişi Japon döner somunlu. 30° ters konik. Metrik dış.

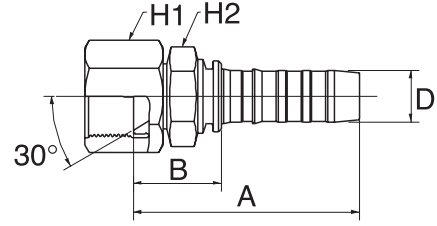

D			A B H1 H2				REF.	
-ölçü	DN	"	mm	mm	mm	mm	GS	
-8	12	1/2	M22 x 1,5	61,4	24,0	27,0	27,0	8GS8FKX
-10	16	5/8	M24 x 1,5	80,0	29,7	32,0	30,0	10GS10FKX
-12	20	3/4	M30 x 1,5	83,7	32,7	36,0	32,0	12GS12FKX
-16	25	1	M33 x 1,5	92,6	36,2	41,0	41,0	16GS16FKX

SAE FFORX

Dişi SAE düz alınlı 'O' ringli döner somunlu.

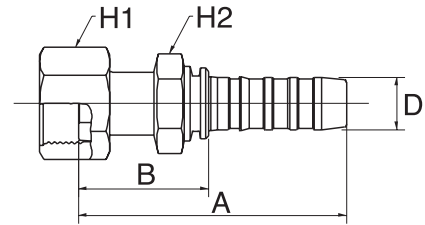

D			A B H1 H2				REF.	
-ölçü	DN	"	mm	mm	mm	mm	GS	
-6	10	3/8	11/16" - 16 UN	69,0	33,2	22,0	22,0	6GS6FFORX
-6	10	3/8	13/16" - 16 UN	72,0	36,2	24,0	22,0	6GS8FFORX
-8	12	1/2	13/16" - 16 UN	71,5	34,0	24,0	27,0	8GS8FFORX
-8	12	1/2	1" - 14 UNS	78,0	40,5	30,0	27,0	8GS10FFORX
-8	12	1/2	1 3/16" - 12 UN	79,0	41,5	36,0	27,0	8GS12FFORX
-10	16	5/8	1" - 14 UNS	93,0	42,7	30,0	30,0	10GS10FFORX
-10	16	5/8	1 3/16" - 12 UN	95,0	44,7	36,0	30,0	10GS12FFORX
-12	20	3/4	1" - 14 UNS	97,0	46,0	30,0	32,0	12GS10FFORX
-12	20	3/4	1 3/16" - 12 UN	100,5	49,5	36,0	32,0	12GS12FFORX
-12	20	3/4	1 7/16" - 12 UN	103,0	52,0	41,0	32,0	12GS16FFORX
-12	20	3/4	1 11/16" - 12 UN	99,3	48,3	50,0	32,0	12GS20FFORX
-16	25	1	1 7/16" - 12 UN	111,0	54,6	41,0	41,0	16GS16FFORX
-16	25	1	1 11/16" - 12 UN	110,7	54,3	50,0	41,0	16GS20FFORX
-20	32	1 1/4	1 11/16" - 12 UN	128,0	56,9	50,0	50,0	20GS20FFORX
-20	32	1 1/4	2" - 12 UN	130,0	58,9	60,0	50,0	20GS24FFORX (1)
-24	40	1 1/2	2" - 12 UN	164,4	69,4	60,0	55,0	24GS24FFORX
-24	40	1 1/2	2" - 12 UN	137,0	63,4	60,0	55,0	24GSP24FFORX

-6 ila -20 ölçüleri 42,0 MPa'dır (6000 psi). / (1) ila 28,0 MPa (4000 psi) arasındadır.

Aksi belirtilmedikçe Kaplin, ilgili uluslararası standardın basınç ölçüm gereksinimlerini karşılar.

SAE FFORX45S

Dişi SAE düz alınlı 'O' ringli döner somunlu. 45° dirsek. Kısa boyunlu (-6 ila -16 Boyun uzunluğu ISO 12151-1'i karşılar).

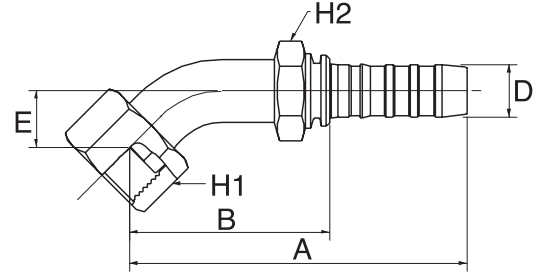

↔			🌀	↔	↔				🌀
D				A	B	E	H1	H2	REF.
-ölçü	DN	"		mm	mm	mm	mm	mm	GS
-6	10	3/8	11/16" - 16 UN	82,0	46,2	11,0	22,0	22,0	6GS6FFORX45S
-6	10	3/8	13/16" - 16 UN	93,0	57,2	15,0	24,0	22,0	6GS8FFORX45S
-8	12	1/2	13/16" - 16 UN	94,0	56,5	15,0	24,0	27,0	8GS8FFORX45S
-8	12	1/2	1" - 14 UNS	99,0	61,5	16,0	30,0	27,0	8GS10FFORX45S
-10	16	5/8	1" - 14 UNS	111,0	60,7	16,0	30,0	30,0	10GS10FFORX45S
-12	20	3/4	1 3/16" - 12 UN	125,0	74,0	21,0	36,0	32,0	12GS12FFORX45S
-12	20	3/4	1 7/16" - 12 UN	137,0	86,0	24,0	41,0	32,0	12GS16FFORX45S
-16	25	1	1 7/16" - 12 UN	144,0	87,6	24,0	41,0	41,0	16GS16FFORX45S
-16	25	1	1 11/16" - 12 UN	164,0	107,6	25,0	50,0	41,0	16GS20FFORX45S
-20	32	1 1/4	1 11/16" - 12 UN	180,0	109,0	32,0	50,0	50,0	20GS20FFORX45-032
-24	40	1 1/2	2" - 12 UN	236,6	141,4	38,0	60,0	55,0	24GS24FFORX45M

-6 ila -20 ölçüleri 42,0 MPa'dır (6000 psi). / M: Orta boyunlu.

SAE FFORX90S

Dişi SAE düz alınlı 'O' ringli döner somunlu. 90° dirsek. Kısa boyunlu (-6 ila -20 Boyun uzunluğu ISO 12151-1'i karşılar).

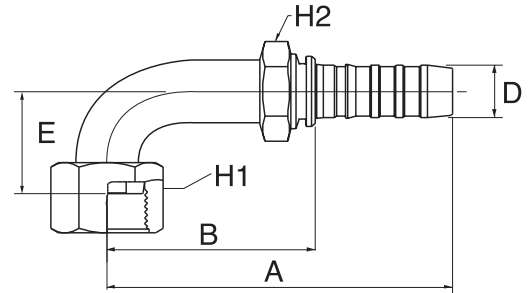

↔			🌀	↔	↔				🌀
D				A	B	E	H1	H2	REF.
-ölçü	DN	"		mm	mm	mm	mm	mm	GS
-6	10	3/8	11/16" - 16 UN	78,0	42,2	23,1	22,0	22,0	6GS6FFORX90S
-8	12	1/2	13/16" - 16 UN	86,0	48,5	29,0	24,0	27,0	8GS8FFORX90S
-8	12	1/2	1 3/16" - 12 UN	107,0	69,6	48,0	36,0	27,0	8GS12FFORX90S
-10	16	5/8	1" - 14 UNS	106,6	56,3	32,0	30,0	30,0	10GS10FFORX90S
-12	20	3/4	1" - 14 UNS	111,0	59,9	32,0	30,0	32,0	12GS10FFORX90S
-12	20	3/4	1 3/16" - 12 UN	128,0	77,0	48,0	36,0	32,0	12GS12FFORX90S
-12	20	3/4	1 7/16" - 12 UN	137,0	86,1	55,9	41,0	32,0	12GS16FFORX90S
-16	25	1	1 7/16" - 12 UN	144,0	87,6	55,9	41,0	41,0	16GS16FFORX90S
-16	25	1	1 11/16" - 12 UN	151,1	94,7	64,0	50,0	41,0	16GS20FFORX90S
-20	32	1 1/4	1 11/16" - 12 UN	172,0	100,8	64,0	50,0	50,0	20GS20FFORX90S
-20	32	1 1/4	2" - 12 UN	172,0	100,9	64,0	60,0	(N.A.)	20GS24FFORX90-064

-6 ila -20 ölçüleri 42,0 MPa'dır (6000 psi). / (N.A.): Uygun değil.

Aksi belirtilmedikçe Kaplin, ilgili uluslararası standardın basınç ölçüm gereksinimlerini karşılar.

SAE FFORX90M

Dişi SAE düz alınlı 'O' ringli döner somunlu. 90° dirsek. Orta boyunlu (-6 ila -24 Boyun uzunluğu ISO 12151-1'i karşılar).

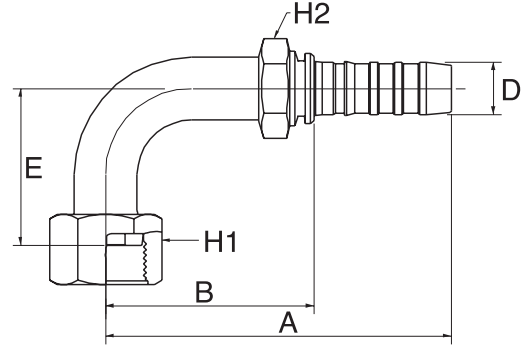

D				A B E H1 H2					REF.
-ölçü	DN	"		mm	mm	mm	mm	mm	GS
-6	10	3/8	13/16" - 16 UN	85,0	49,2	41,0	24,0	22,0	6GS8FFORX90M
-8	12	1/2	1 3/16" - 12 UN	101,0	63,5	47,0	30,0	27,0	8GS10FFORX90M
-10	16	5/8	1" - 14 UNS	107,0	56,7	47,0	30,0	30,0	10GS10FFORX90M
-12	20	3/4	1 3/16" - 12 UN	128,0	77,0	58,0	36,0	32,0	12GS12FFORX90M
-16	25	1	1 7/16" - 12 UN	144,0	87,6	71,0	41,0	41,0	16GS16FFORX90M
-16	25	1	1 11/16" - 12 UN	153,6	97,2	78,0	50,0	41,0	16GS20FFORX90M
-20	32	1 1/4	1 11/16" - 12 UN	172,0	100,8	78,0	50,0	50,0	20GS20FFORX90M
-24	40	1 1/2	2" - 12 UN	227,4	132,3	86,0	60,0	55,0	24GS24FFORX90M

-6 ila -20 ölçüleri 42,0 MPa'dır (6000 psi).

SAE FFORX90L

Dişi SAE düz alınlı 'O' ringli döner somunlu. 90° dirsek. Uzun boyunlu (-6 ila -20 Boyun uzunluğu ISO 12151-1'i karşılar).

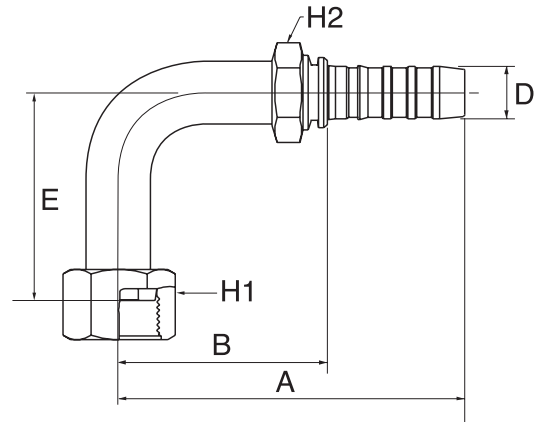

D				A B E H1 H2					REF.
-ölçü	DN	"		mm	mm	mm	mm	mm	GS
-6	10	3/8	11/16" - 16 UN	85,0	49,2	54,0	22,0	22,0	6GS6FFORX90L
-8	12	1/2	13/16" - 16 UN	86,0	48,5	83,0	24,0	27,0	8GS8FFORX90-083
-10	16	5/8	1" - 14 UNS	113,0	62,7	70,0	30,0	30,0	10GS10FFORX90L
-12	20	3/4	1 3/16" - 12 UN	128,0	77,0	96,0	36,0	32,0	12GS12FFORX90L
-16	25	1	1 7/16" - 12 UN	144,0	87,6	114,0	41,0	41,0	16GS16FFORX90L
-20	32	1 1/4	1 11/16" - 12 UN	172,0	100,9	129,0	50,0	50,0	20GS20FFORX90L

-6 ila -20 ölçüleri 42,0 MPa'dır (6000 psi).

Aksi belirtilmedikçe Kaplin, ilgili uluslararası standardın basınç ölçüm gereksinimlerini karşılar.

SAE MFFOR

Erkek SAE düz alınlı 'O' ringli.

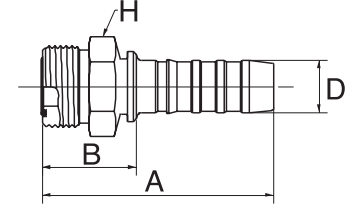

↔			🌀	↔			🔧
D				A	B	H	REF.
-ölçü	DN	"		mm	mm	mm	GS
-6	10	3/8	11/16" - 16 UN	64,0	28,2	19,0	6GS6MFFOR
-8	12	1/2	13/16" - 16 UN	68,0	30,5	22,0	8GS8MFFOR
-12	20	3/4	1 3/16" - 12 UN	89,0	38,0	32,0	12GS12MFFOR
-12	20	3/4	1 7/16" - 12 UN	95,0	44,0	41,0	12GS16MFFOR
-16	25	1	1 7/16" - 12 UN	102,0	45,2	41,0	16GS16MFFOR
-20	32	1 1/4	1 11/16" - 12 UN	120,0	48,9	46,0	20GS20MFFOR

-6 ila -20 ölçüleri 42,0 MPa'dır (6000 psi).

SAE FL

SAE 'O' ringli flanş. Kod 61.

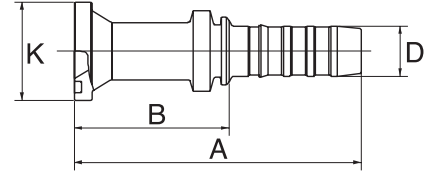

↔			🔧	↔			🔧	
D				A	B	K	KIT	REF.
-ölçü	DN	"		mm	mm	mm		GS
-6	10	3/8	1/2"	90,0	54,2	30,2	8 PA-FL	6GS8FL
-8	12	1/2	1/2"	93,0	55,5	30,2	8 PA-FL	8GS8FL
-8	12	1/2	3/4"	98,0	60,5	38,1	12 PA-FL	8GS12FL
-10	16	5/8	3/4"	109,0	58,7	38,1	12 PA-FL	10GS12FL
-12	20	3/4	1/2"	112,0	61,0	30,2	8 PA-FL	12GS8FL
-12	20	3/4	3/4"	111,0	60,0	38,1	12 PA-FL	12GS12FL
-12	20	3/4	1"	111,0	60,0	44,5	16 PA-FL	12GS16FL
-12	20	3/4	1 1/4"	111,0	56,6	50,8	20 PA-FL	12GS20FL
-16	25	1	1"	125,0	68,6	44,5	16 PA-FL	16GS16FL
-16	25	1	1 1/4"	125,0	64,0	50,8	20 PA-FL	16GS20FL
-16	25	1	1 1/2"	125,0	64,0	60,3	24 PA-FL	16GS24FL
-20	32	1 1/4	1"	136,0	64,9	44,5	16 PA-FL	20GS16FL
-20	32	1 1/4	1 1/4"	146,0	74,9	50,8	20 PA-FL	20GS20FL
-20	32	1 1/4	1 1/2"	160,0	88,9	60,3	24 PA-FL	20GS24FL
-24	40	1 1/2	1 1/2"	152,9	79,3	60,3	24 PA-FL	24GSP24FL
-24	40	1 1/2	2"	152,9	79,3	71,4	32 PA-FL	24GSP32FL
-32	50	2	2"	159,3	67,3	71,4	32 PA-FL	32GSP32FL

Kod 61: -6, -8, -10, -12, -16: 35,0 MPa (5000 psi); -20: 28,0 MPa (4000 psi); -24 ve -32: 21,0 MPa (3000 psi). / Flanş kitleri hakkında detaylar için bkz. sayfa 218.

Aksi belirtilmedikçe Kaplin, ilgili uluslararası standardın basınç ölçüm gereksinimlerini karşılar.

SAE FL22M

SAE 'O' ringli flanş. Kod 61. 22° dirsek.
Orta boyunlu (-8 ila -20 Boyun uzunluğu
ISO 12151-3'ü karşılar).

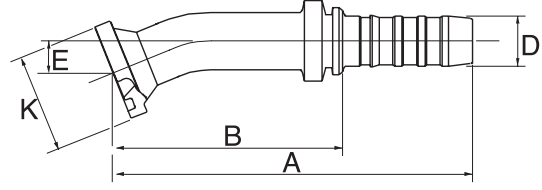

↔				↔					
D				A	B	E	K	KIT	REF.
-ölçü	DN	"		mm	mm	mm	mm		GS
-8	12	1/2	1/2"	96,0	58,5	9,0	30,2	8 PA-FL	8GS8FL22M
-12	20	3/4	3/4"	131,0	80,0	11,0	38,1	12 PA-FL	12GS12FL22M
-12	20	3/4	1"	133,0	82,0	14,0	44,5	16 PA-FL	12GS16FL22M
-16	25	1	1"	155,0	98,6	14,0	44,5	16 PA-FL	16GS16FL22M
-16	25	1	1 1/4"	168,0	111,4	15,0	50,8	20 PA-FL	16GS20FL22M
-20	32	1 1/4	1 1/4"	178,0	106,9	15,0	50,8	20 PA-FL	20GS20FL22M
-20	32	1 1/4	1 1/2"	186,0	114,9	18,0	60,3	24 PA-FL	20GS24FL22M

Kod 61: -6, -8, -10, -12, -16: 35,0 MPa (5000 psi); -20: 28,0 MPa (4000 psi); -24 ve -32: 21,0 MPa (3000 psi). / Flanş kitleri hakkında detaylar için bkz. sayfa 218.

SAE FL30M

SAE 'O' ringli flanş. Kod 61. 30° dirsek.
Orta boyunlu (-8 ila -20 Boyun uzunluğu
ISO 12151-3'ü karşılar).

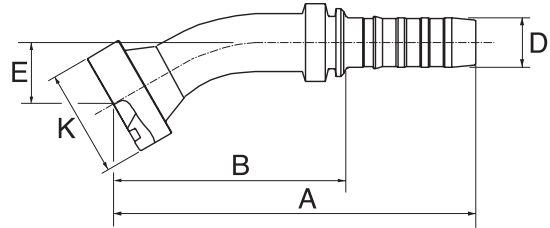

↔				↔					
D				A	B	E	K	KIT	REF.
-ölçü	DN	"		mm	mm	mm	mm		GS
-12	20	3/4	3/4"	129,0	78,0	16,0	38,1	12 PA-FL	12GS12FL30M
-12	20	3/4	1"	121,0	70,0	19,0	44,5	16 PA-FL	12GS16FL30M
-16	25	1	1"	153,0	96,6	19,0	44,5	16 PA-FL	16GS16FL30M
-16	25	1	1 1/4"	166,0	109,0	22,0	50,8	20 PA-FL	16GS20FL30M
-20	32	1 1/4	1 1/4"	176,0	104,9	22,0	50,8	20 PA-FL	20GS20FL30M
-20	32	1 1/4	1 1/2"	182,0	110,9	30,0	60,3	24 PA-FL	20GS24FL30M
-24	40	1 1/2	1 1/2"	209,0	135,2	25,0	60,4	24 PA-FL	24GSP24FL30S

Kod 61: -6, -8, -10, -12, -16: 35,0 MPa (5000 psi); -20: 28,0 MPa (4000 psi); -24 ve -32: 21,0 Mpa (3000 psi). / S: Kısa boyunlu. / Flanş kitleri hakkında detaylar için bkz. sayfa 218.

Aksi belirtilmedikçe Kaplin, ilgili uluslararası standardın basınç ölçüm gereksinimlerini karşılar.

SAE FL45

SAE 'O' ringli flanş. Kod 61. 45° dirsek.
-6 ila -24 ölçüleri için küçük ve orta Boyun uzunluğu ISO 12151-3'ü karşılar.

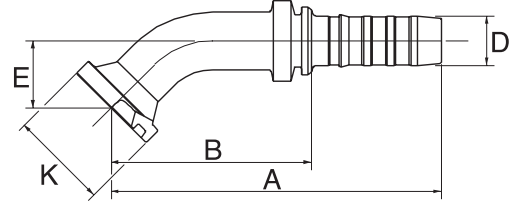

↻			🔧	↔				🔧	🔧
D				A	B	E	K	KIT	REF.
-ölçü	DN	"		mm	mm	mm	mm		GS
-6	10	3/8	1/2"	93,0	57,2	19,0	30,2	8 PA-FL	6GS8FL45M
-8	12	1/2	1/2"	94,0	56,5	19,0	30,2	8 PA-FL	8GS8FL45M
-8	12	1/2	3/4"	101,0	63,5	26,0	38,1	12 PA-FL	8GS12FL45M
-10	16	5/8	3/4"	127,0	76,7	26,0	38,1	12 PA-FL	10GS12FL45M
-12	20	3/4	3/4"	124,0	73,0	26,0	38,1	12 PA-FL	12GS12FL45M
-12	20	3/4	1"	126,0	75,0	28,0	44,5	16 PA-FL	12GS16FL45S
-16	25	1	1"	147,0	90,6	32,0	44,5	16 PA-FL	16GS16FL45M
-16	25	1	1 1/4"	158,0	100,8	38,0	50,8	20 PA-FL	16GS20FL45M
-20	32	1 1/4	1"	163,0	91,9	32,0	44,5	16 PA-FL	20GS16FL45M
-20	32	1 1/4	1 1/4"	170,0	98,9	32,0	50,8	20 PA-FL	20GS20FL45S
-20	32	1 1/4	1 1/2"	176,0	104,9	38,0	60,3	24 PA-FL	20GS24FL45S
-24	40	1 1/2	1 1/2"	202,0	128,6	38,0	60,4	24 PA-FL	24GSP24FL45S
-24	40	1 1/2	2"	200,0	126,3	52,0	71,4	32 PA-FL	24GSP32FL45S
-32	50	2	2"	257,0	165,0	66,0	71,4	32 PA-FL	32GSP32FL45-066

Kod 61: -6, -8, -10, -12, -16: 35,0 MPa (5000 psi); -20: 28,0 MPa (4000 psi); -24 ve -32: 21,0 MPa (3000 psi). / Flanş kitleri hakkında detaylar için bkz. sayfa 218.

SAE FL60M

SAE 'O' ringli flanş. Kod 61. 60° dirsek.
Orta boyunlu (-8 ila -20 Boyun uzunluğu ISO 12151-3'ü karşılar).

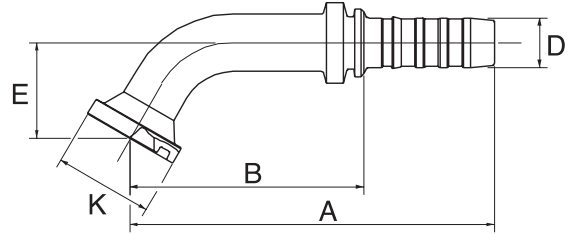

↻			🔧	↔				🔧	🔧
D				A	B	E	K	KIT	REF.
-ölçü	DN	"		mm	mm	mm	mm		GS
-8	12	1/2	1/2"	104,0	66,5	27,0	30,2	8 PA-FL	8GS8FL60M
-12	20	3/4	3/4"	137,0	86,0	37,0	38,1	12 PA-FL	12GS12FL60M
-12	20	3/4	1"	136,0	85,0	44,0	44,5	16 PA-FL	12GS16FL60M
-16	25	1	1"	157,0	100,6	44,0	44,5	16 PA-FL	16GS16FL60M
-16	25	1	1 1/4"	157,0	100,2	55,0	50,8	20 PA-FL	16GS20FL60M
-20	32	1 1/4	1 1/4"	187,0	115,9	55,0	54,0	20 PA-FL	20GS20FL60M
-20	32	1 1/4	1 1/2"	195,0	123,9	64,0	60,3	24 PA-FL	20GS24FL60M
-24	40	1 1/2	1 1/2"	231,0	157,5	53,0	60,4	24 PA-FL	24GSP24FL60S

Kod 61: -6, -8, -10, -12, -16: 35,0 MPa (5000 psi); -20: 28,0 MPa (4000 psi); -24 ve -32: 21,0 MPa (3000 psi). / S: Kısa boyunlu. / Flanş kitleri hakkında detaylar için bkz. sayfa 218.

Aksi belirtilmedikçe Kaplin, ilgili uluslararası standardın basınç ölçüm gereksinimlerini karşılar.

SAE FL67M

SAE 'O' ringli flanş. Kod 61. 67° dirsek.
Orta boyunlu (-12 ila -20 Boyun uzunluğu
ISO 12151-3'ü karşılar).

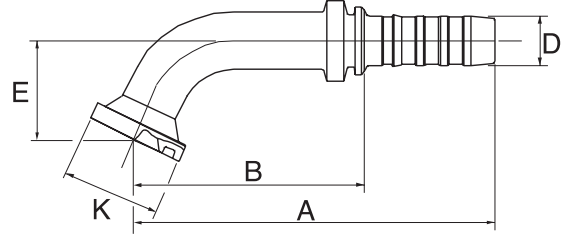

↔				↔					
D				A	B	E	K	KIT	REF.
-ölçü	DN	"		mm	mm	mm	mm		GS
-12	20	3/4	3/4"	132,0	81,0	42,0	38,1	12 PA-FL	12GS12FL67M
-12	20	3/4	1"	129,0	78,0	51,0	44,5	16 PA-FL	12GS16FL67M
-16	25	1	1"	151,0	94,6	51,0	44,5	16 PA-FL	16GS16FL67M
-16	25	1	1 1/4"	148,0	91,2	64,0	50,8	20 PA-FL	16GS20FL67M
-20	32	1 1/4	1 1/4"	179,0	107,7	64,0	50,8	20 PA-FL	20GS20FL67M

Kod 61: -6, -8, -10, -12, -16: 35,0 MPa (5000 psi); -20: 28,0 MPa (4000 psi); -24 ve -32: 21,0 MPa (3000 psi). / Flanş kitleri hakkında detaylar için bkz. sayfa 218.

SAE FL90S

SAE 'O' ringli flanş. Kod 61. 90° dirsek.
Kısa boyunlu (-12 ila -24 Boyun uzunluğu
ISO 12151-3'ü karşılar).

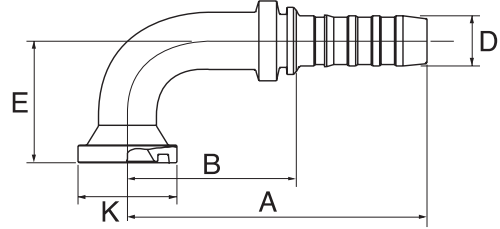

↔				↔					
D				A	B	E	K	KIT	REF.
-ölçü	DN	"		mm	mm	mm	mm		GS
-12	20	3/4	1"	128,0	77,0	61,0	44,5	16 PA-FL	12GS16FL90S
-16	25	1	1"	135,0	78,6	61,0	44,5	16 PA-FL	16GS16FL90S
-16	25	1	1 1/4"	134,0	76,8	68,0	50,8	20 PA-FL	16GS20FL90S
-16	25	1	1 1/2"	134,0	77,2	81,0	60,3	24 PA-FL	16GS24FL90S
-20	32	1 1/4	1 1/4"	165,0	93,9	68,0	50,8	20 PA-FL	20GS20FL90S
-20	32	1 1/4	1 1/2"	166,0	94,9	81,0	60,3	24 PA-FL	20GS24FL90S
-24	40	1 1/2	1 1/2"	184,0	109,9	81,0	60,4	24 PA-FL	24GSP24FL90S

Kod 61: -6, -8, -10, -12, -16: 35,0 MPa (5000 psi); -20: 28,0 MPa (4000 psi); -24 ve -32: 21,0 MPa (3000 psi). / Flanş kitleri hakkında detaylar için bkz. sayfa 218.

Aksi belirtilmedikçe Kaplin, ilgili uluslararası standardın basınç ölçüm gereksinimlerini karşılar.

SAE FL90M

SAE 'O' ringli flanş. Kod 61. 90° dirsek.
Orta boyunlu (-6 ila -20 Boyun uzunluğu
ISO 12151-3'ü karşılar).

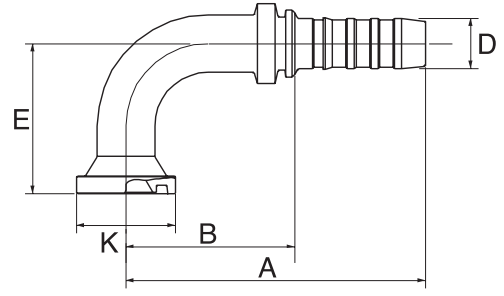

D			A B E K				KIT	REF.
-ölçü	DN	"	mm	mm	mm	mm	GS	
-6	10	3/8	87,0	51,2	40,0	30,2	8 PA-FL	6GS8FL90M
-8	12	1/2	88,0	50,5	40,0	30,2	8 PA-FL	8GS8FL90M
-8	12	1/2	88,0	50,4	58,0	38,1	12 PA-FL	8GS12FL90M
-10	16	5/8	110,0	59,7	58,0	38,1	12 PA-FL	10GS12FL90M
-12	20	3/4	122,0	71,0	50,0	30,2	8 PA-FL	12GS8FL90-050
-12	20	3/4	112,0	61,0	58,0	38,1	12 PA-FL	12GS12FL90M
-12	20	3/4	128,0	77,0	70,0	44,5	16 PA-FL	12GS16FL90M
-16	25	1	135,0	78,6	70,0	44,5	16 PA-FL	16GS16FL90M
-16	25	1	134,0	76,8	90,0	50,8	20 PA-FL	16GS20FL90M
-16	25	1	145,0	88,2	60,0	60,3	24 PA-FL	16GS24FL90-060
-20	32	1 1/4	160,0	88,9	70,0	44,5	16 PA-FL	20GS16FL90M
-20	32	1 1/4	166,0	94,9	90,0	50,8	20 PA-FL	20GS20FL90M
-20	32	1 1/4	165,0	93,9	118,0	60,3	24 PA-FL	20GS24FL90-118
-24	40	1 1/2	175,0	101,9	80,0	71,4	32 PA-FL	24GSP32FL90-080
-32	50	2	222,0	130,1	114,0	71,4	32 PA-FL	32GSP32FL90-114

Kod 61: -6, -8, -10, -12, -16: 35,0 MPa (5000 psi); -20: 28,0 MPa (4000 psi); -24 ve -32: 21,0 MPa (3000 psi). / Flanş kitleri hakkında detaylar için bkz. sayfa 218.

SAE FL90L

SAE 'O' ringli flanş. Kod 61. 90° dirsek.
Uzun boyunlu.

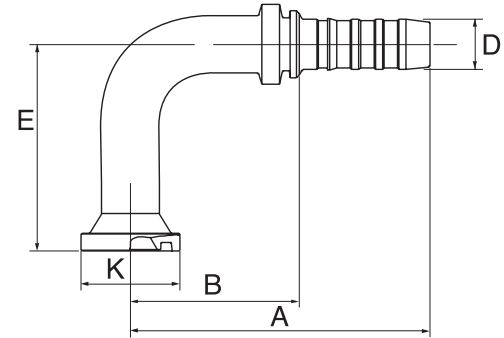

D			A B E K				KIT	REF.
-ölçü	DN	"	mm	mm	mm	mm	GS	
-10	16	5/8	110,0	59,7	100,0	38,1	12 PA-FL	10GS12FL90-100
-12	20	3/4	122,0	71,0	100,0	38,1	12 PA-FL	12GS12FL90-100
-12	20	3/4	122,0	71,0	125,0	38,1	12 PA-FL	12GS12FL90-125
-12	20	3/4	116,0	65,0	150,0	38,1	12 PA-FL	12GS12FL90-150
-12	20	3/4	116,0	65,0	100,0	44,5	16 PA-FL	12GS16FL90-100
-16	25	1	135,0	78,6	100,0	44,5	16 PA-FL	16GS16FL90-100
-16	25	1	134,0	77,6	120,0	44,5	16 PA-FL	16GS16FL90-120
-20	32	1 1/4	166,0	94,9	168,0	50,8	20 PA-FL	20GS20FL90-168

Kod 61: -6, -8, -10, -12, -16: 35,0 MPa (5000 psi); -20: 28,0 MPa (4000 psi); -24 ve -32: 21,0 MPa (3000 psi). / Flanş kitleri hakkında detaylar için bkz. sayfa 218.

Aksi belirtilmedikçe Kaplin, ilgili uluslararası standardın basınç ölçüm gereksinimlerini karşılar.

SAE FLH

Yüksek basınçlı SAE 'O' ringli flanş. Kod 62.

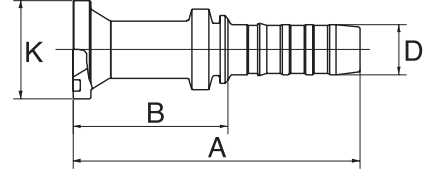

↔				↔					
D				A	B	K	KIT	KIT	REF.
-ölçü	DN	"		mm	mm	mm			GS
-8	12	1/2	1/2"	93,0	55,5	31,8	8 PH-FLH	8FLHCFM	8GS8FLH
-8	12	1/2	3/4"	93,0	55,5	41,3	12 PH-FLH	12FLHCFM	8GS12FLH
-10	16	5/8	1/2"	109,0	58,7	31,8	8 PH-FLH		10GS8FLH
-10	16	5/8	3/4"	109,0	58,7	41,3	12 PH-FLH	12FLHCFM	10GS12FLH
-12	20	3/4	3/4"	114,0	63,0	41,3	12 PH-FLH	12FLHCFM	12GS12FLH
-12	20	3/4	1"	114,0	63,0	47,6	16 PH-FLH	16FLHCFM	12GS16FLH
-16	25	1	3/4"	129,0	72,6	41,3	12 PH-FLH		16GS12FLH
-16	25	1	1"	125,0	68,6	47,6	16 PH-FLH	16FLHCFM	16GS16FLH
-16	25	1	1 1/4"	125,0	64,0	54,0	20 PH-FLH	20FLHCFM	16GS20FLH
-20	32	1 1/4	1"	163,0	97,9	47,6	16 PH-FLH		20GS16FLH
-20	32	1 1/4	1 1/4"	146,0	74,9	54,0	20 PH-FLH	20FLHCFM	20GS20FLH
-20	32	1 1/4	1 1/2"	160,0	88,9	63,5	24 PH-FLH	24FLHCFM	20GS24FLH
-24	40	1 1/2	1 1/2"	200,0	105,0	63,5	24 PH-FLH		24GSH24FLH
-24	40	1 1/2	2"	200,0	105,0	79,5	32 PH-FLH		24GSH32FLH
-32	50	2	1 1/2"	229,6	115,6	63,5	24 PH-FLH		32GSH24FLH
-32	50	2	2"	251,4	137,4	79,5	32 PH-FLH		32GSH32FLH

-8 ila -32 ölçüleri 42,0 MPa'dır (6000 psi). / Flanş kitleri hakkında detaylar için bkz. sayfa 218.

SAE FLH22M

Yüksek basınçlı SAE 'O' ringli flanş. Kod 62.
22° dirsek. Orta boyunlu (-16 ila -24 Boyun uzunluğu ISO 12151-3'ü karşılar).

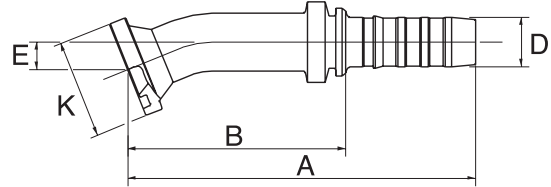

↔				↔						
D				A	B	E	K	KIT	KIT	REF.
-ölçü	DN	"		mm	mm	mm	mm			GS
-16	25	1	1"	155,0	98,6	14,0	47,6	16 PH-FLH	16FLHCFM	16GS16FLH22M
-20	32	1 1/4	1 1/4"	186,0	114,9	15,0	54,0	20 PH-FLH		20GS20FLH22M
-20	32	1 1/4	1 1/2"	188,0	116,9	18,0	63,5	24 PH-FLH	24FLHCFM	20GS24FLH22M
-24	40	1 1/2	1 1/2"	243,0	148,4	18,0	63,5	24 PH-FLH		24GSH24FLH22M

-16 ila -24 ölçüleri 42,0 MPa'dır (6000 psi). / Flanş kitleri hakkında detaylar için bkz. sayfa 218.

Aksi belirtilmedikçe Kaplin, ilgili uluslararası standardın basınç ölçüm gereksinimlerini karşılar.

SAE FLH30M

Yüksek basınçlı SAE 'O' ringli flanş. Kod 62.
30° dirsek. Orta boyunlu (-16 ila -20 Boyun
uzunluğu ISO 12151-3'ü karşılar).

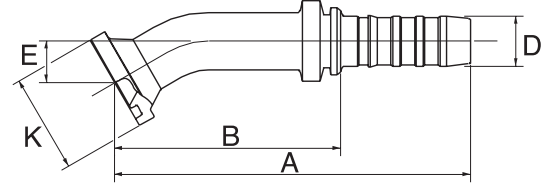

D			A B E K				KIT		REF.
-ölçü	DN	"	mm	mm	mm	mm		GS	
-16	25	1	153,0	96,6	19,0	47,6	16 PH-FLH	16FLHCFM	16GS16FLH30M
-16	25	1	166,0	109,1	22,0	54,0	20 PH-FLH	20FLHCFM	16GS20FLH30M
-20	32	1 1/4	184,0	112,9	22,0	54,0	20 PH-FLH		20GS20FLH30M
-20	32	1 1/4	184,0	112,9	30,0	63,5	24 PH-FLH	24FLHCFM	20GS24FLH30M
-24	40	1 1/2	240,0	144,8	30,0	63,5	24 PH-FLH		24GSH24FLH30

-16 ila -24 ölçüleri 42,0 MPa'dır (6000 psi). / Flanş kitleri hakkında detaylar için bkz. sayfa 218.

SAE FLH45M

Yüksek basınçlı SAE 'O' ringli flanş. Kod 62.
45° dirsek. Orta boyunlu (-8 ila -20 Boyun
uzunluğu ISO 12151-3'ü karşılar).

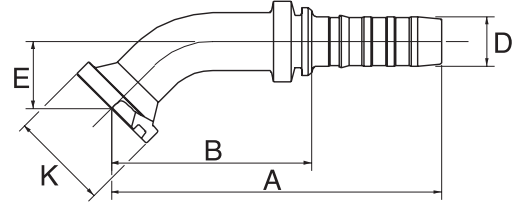

D			A B E K				KIT		REF.
-ölçü	DN	"	mm	mm	mm	mm		GS	
-8	12	1/2	94,0	56,5	19,0	31,8	8 PH-FLH	8FLHCFM	8GS8FLH45M
-8	12	1/2	101,0	63,5	26,0	41,3	12 PH-FLH	12FLHCFM	8GS12FLH45M
-10	16	5/8	115,0	64,7	19,0	31,8	8 PH-FLH		10GS8FLH45M
-10	16	5/8	127,0	76,7	26,0	41,3	12 PH-FLH	12FLHCFM	10GS12FLH45M
-12	20	3/4	124,0	73,0	26,0	41,3	12 PH-FLH	12FLHCFM	12GS12FLH45M
-12	20	3/4	130,0	79,0	32,0	47,6	16 PH-FLH	16FLHCFM	12GS16FLH45M
-16	25	1	141,0	84,2	26,0	41,3	12 PH-FLH		16GS16FLH45M
-16	25	1	147,0	90,6	32,0	47,6	16 PH-FLH	16FLHCFM	16GS16FLH45M
-16	25	1	158,0	101,2	38,0	54,0	20 PH-FLH	20FLHCFM	16GS20FLH45M
-20	32	1 1/4	191,1	120,0	33,7	47,6	16 PH-FLH		20GS16FLH45
-20	32	1 1/4	176,0	104,9	38,0	54,0	20 PH-FLH	20FLHCFM	20GS20FLH45M
-20	32	1 1/4	176,0	104,9	44,0	63,5	24 PH-FLH	24FLHCFM	20GS24FLH45M
-24	40	1 1/2	232,0	137,0	44,0	63,5	24 PH-FLH		24GSH24FLH45
-24	40	1 1/2	241,0	146,0	56,0	79,5	32 PH-FLH		24GSH32FLH45M
-32	50	2	296,5	182,5	63,0	79,5	32 PH-FLH		32GSH32FLH45-063

-8 ila -32 ölçüleri 42,0 MPa'dır (6000 psi). / Flanş kitleri hakkında detaylar için bkz. sayfa 218.

Aksi belirtilmedikçe Kaplin, ilgili uluslararası standardın basınç ölçüm gereksinimlerini karşılar.

SAE FLH60M

Yüksek basınçlı SAE 'O' ringli flanş. Kod 62. 60° dirsek. Orta boyunlu (-12 ila -24 Boyun uzunluğu ISO 12151-3'ü karşılar).

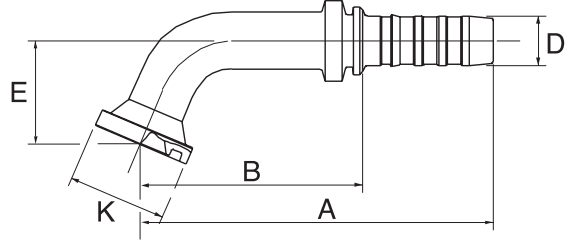

D			A B E K				KIT	KIT	REF.
-ölçü	DN	"	mm	mm	mm	mm		GS	
-12	20	3/4	137,0	86,0	37,0	41,3	12 PH-FLH	12FLHCFM	12GS12FLH60M
-12	20	3/4	136,0	85,0	44,0	47,6	16 PH-FLH	16FLHCFM	12GS16FLH60M
-16	25	1	157,0	100,6	44,0	47,6	16 PH-FLH	16FLHCFM	16GS16FLH60M
-20	32	1 1/4	186,0	114,9	55,0	54,0	20 PH-FLH		20GS20FLH60M
-20	32	1 1/4	194,0	122,9	64,0	63,5	24 PH-FLH	24FLHCFM	20GS24FLH60M
-24	40	1 1/2	253,0	156,2	64,0	63,5	24 PH-FLH		24GSH24FLH60M

-12 ila -24 ölçüleri 42,0 MPa'dır (6000 psi). / Flanş kitleri hakkında detaylar için bkz. sayfa 218.

SAE FLH90S

Yüksek basınçlı SAE 'O' ringli flanş. Kod 62. 90° dirsek. Kısa boyunlu (-16 ila -20 Boyun uzunluğu ISO 12151-3'ü karşılar).

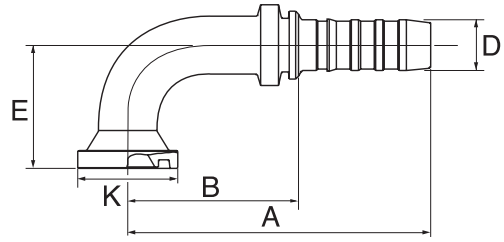

D			A B E K				KIT	KIT	REF.
-ölçü	DN	"	mm	mm	mm	mm		GS	
-16	25	1	135,0	78,6	61,0	47,6	16 PH-FLH	16FLHCFM	16GS16FLH90S
-16	25	1	134,0	76,8	68,0	54,0	20 PH-FLH	20FLHCFM	16GS20FLH90S
-16	25	1	134,0	77,2	81,0	63,5	24 PH-FLH	24FLHCFM	16GS24FLH90
-20	32	1 1/4	160,0	88,9	61,0	47,6	16 PH-FLH		20GS16FLH90S
-20	32	1 1/4	165,0	93,9	81,0	63,5	24 PH-FLH	24FLHCFM	20GS24FLH90S

-12 ila -20 ölçüleri 42,0 MPa'dır (6000 psi). / Flanş kitleri hakkında detaylar için bkz. sayfa 218.

Aksi belirtilmedikçe Kaplin, ilgili uluslararası standardın basınç ölçüm gereksinimlerini karşılar.

SAE FLH90M

Yüksek basınçlı SAE 'O' ringli flanş. Kod 62.
90° dirsek. Orta boyunlu (-8 ila -20 Boyun
uzunluğu ISO 12151-3'ü karşılar).

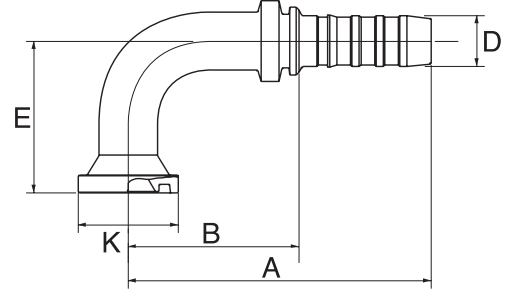

↔			⌢	↔				⌢		⌢
D				A	B	E	K	KIT	KIT	REF.
-ölçü	DN	"		mm	mm	mm	mm			GS
-8	12	1/2	1/2"	88,0	50,5	40,0	31,8	8 PH-FLH	8FLHCFCM	8GS8FLH90M
-8	12	1/2	3/4"	88,0	50,5	58,0	41,3	12 PH-FLH	12FLHCFCM	8GS12FLH90M
-10	16	5/8	1/2"	113,0	62,7	40,0	31,8	8 PH-FLH		10GS8FLH90M
-10	16	5/8	3/4"	110,0	59,7	58,0	41,3	12 PH-FLH	12FLHCFCM	10GS12FLH90M
-12	20	3/4	3/4"	112,0	61,0	58,0	41,3	12 PH-FLH	12FLHCFCM	12GS12FLH90M
-12	20	3/4	1"	132,0	81,0	70,0	47,6	16 PH-FLH	16FLHCFCM	12GS16FLH90M
-16	25	1	3/4"	135,0	78,6	58,0	41,3	12 PH-FLH		16GS12FLH90M
-16	25	1	1"	135,0	78,6	70,0	47,6	16 PH-FLH	16FLHCFCM	16GS16FLH90M
-20	32	1 1/4	1"	160,0	88,9	70,0	47,6	16 PH-FLH		20GS16FLH90M
-20	32	1 1/4	1 1/4"	165,0	93,9	90,0	54,0	20 PH-FLH	20FLHCFCM	20GS20FLH90M
-24	40	1 1/2	1 1/2"	214,0	118,9	94,0	63,5	24 PH-FLH		24GSH24FLH90-094
-24	40	1 1/2	2"	214,0	118,9	120,0	79,5	32 PH-FLH		24GSH32FLH90S
-32	50	2	2"	264,0	150,5	138,0	79,5	32 PH-FLH		32GSH32FLH90M

-8 ila -32 ölçüleri 42,0 MPa'dır (6000 psi). / S: Kısa boyunlu. / Flanş kitleri hakkında detaylar için bkz. sayfa 218.

Aksi belirtilmedikçe Kaplin, ilgili uluslararası standardın basınç ölçüm gereksinimlerini karşılar.

SAE FLH90L

Yüksek basınçlı SAE 'O' ringli flanş. Kod 62.
90° dirsek. Uzun boyunlu.

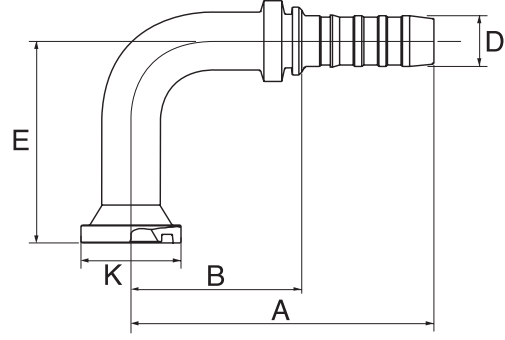

D			A B E K				KIT		REF.
-ölçü	DN	"	mm	mm	mm	mm			GS
-12	20	3/4	112,0	61,0	100,0	41,3	12 PH-FLH	12FLHCFM	12GS12FLH90-100
-16	25	1	135,0	78,2	100,0	47,6	16 PH-FLH	16FLHCFM	16GS16FLH90-100
-16	25	1	134,0	77,6	120,0	47,6	16 PH-FLH	16FLHCFM	16GS16FLH90-120
-16	25	1	134,0	77,2	150,0	47,6	16 PH-FLH	16FLHCFM	16GS16FLH90-150
-20	32	1 1/4	160,0	88,9	100,0	47,6	16 PH-FLH		20GS16FLH90-100
-20	32	1 1/4	165,0	93,9	120,0	54,0	20 PH-FLH		20GS20FLH90-120
-20	32	1 1/4	169,0	97,9	150,0	63,5	24 PH-FLH	24FLHCFM	20GS24FLH90-150
-24	40	1 1/2	214,0	118,9	150,0	63,5	24 PH-FLH		24GSH24FLH90-150

-8 ila -24 ölçüleri 42,0 MPA'dır (6000 psi). / Flanş kitleri hakkında detaylar için bkz. sayfa 218.

Aksi belirtilmedikçe Kaplin, ilgili uluslararası standardın basınç ölçüm gereksinimlerini karşılar.

FLK

Komatsu tipi 'O' ringli flanş.

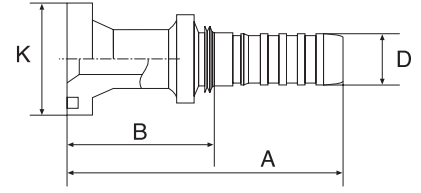

D			A			B		K		REF.	
-ölçü	DN	"	mm	mm	mm	mm	mm	mm	GS		
-8	12	1/2	5/8"	81,5	44,1	34,2	8GS10FLK				
-10	16	5/8	5/8"	114,0	63,7	34,2	10GS10FLK				
-12	20	3/4	5/8"	110,0	59,0	34,2	12GS10FLK				

FLK45

Komatsu tipi 'O' ringli flanş. 45° dirsek.

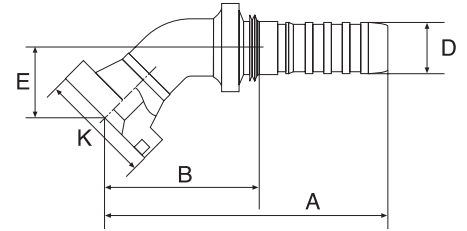

D			A			B		E		K		REF.	
-ölçü	DN	"	mm	mm	mm	mm	mm	mm	mm	GS			
-10	16	5/8	5/8"	121,0	70,7	26,0	34,2	10GS10FLK45-026					

FLK90

Komatsu tipi 'O' ringli flanş. 90° dirsek.

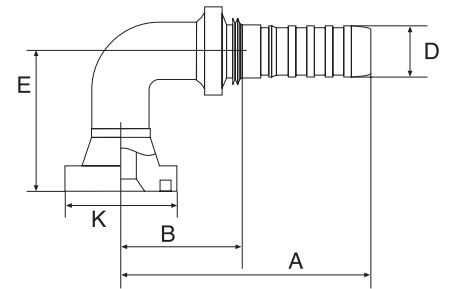

D			A			B		E		K		REF.	
-ölçü	DN	"	mm	mm	mm	mm	mm	mm	mm	GS			
-10	16	5/8	5/8"	110,0	59,7	55,0	34,2	10GS10FLK90-055					
-12	20	3/4	5/8"	118,0	67,0	55,0	34,2	12GS10FLK90-055					

Aksi belirtilmedikçe Kaplin, ilgili uluslararası standardın basınç ölçüm gereksinimlerini karşılar.

FLC

Caterpillar tipi 'O' ringli flanş.

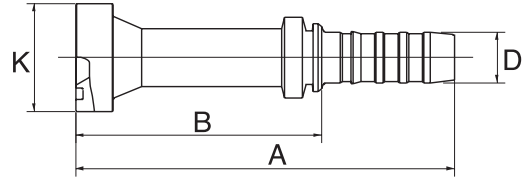

↔				↔			
D				A	B	K	REF.
-ölçü	DN	"		mm	mm	mm	GS
-12	20	3/4	3/4"	145,0	94,0	41,3	12GS12FLC
-12	20	3/4	1"	145,0	94,0	47,6	12GS16FLC
-16	25	1	1"	155,0	98,2	47,6	16GS16FLC
-16	25	1	1 1/4"	155,0	98,2	54,0	16GS20FLC
-20	32	1 1/4	1 1/4"	187,0	115,9	54,0	20GS20FLC
-20	32	1 1/4	1 1/2"	187,0	115,9	63,5	20GS24FLC
-24	40	1 1/2	1 1/2"	189,0	94,3	63,5	24GSH24FLC
-24	40	1 1/2	2"	200,0	105,0	79,5	24GSH32FLC
-32	50	2	2"	227,7	113,7	79,5	32GSH32FLC

-12 ila -20 ölçüleri 42,0 MPa'dır (6000 psi). / Not: FLC flanşları daha kalın bir flanş başlığı ile tasarlanmıştır. 14,2 mm flanş boyutu sıklıkla Caterpillar makinelerinde bulunur. Bu flanş kullanıcının rakorlu hortumu değiştirdiğinde Caterpillar flanş keplerini kullanmasına izin verir. Kullanıcı seçeneğinde, standart Kod 62 flanşları ve kepleri Caterpillar flanşları ve kepleri yerine kullanılabilir. Standart Kod 62 flanş başlığı kalınlığı 7,8 ve 12,6 mm arasında değişir.

FLC22

Caterpillar tipi 'O' ringli flanş. 22° dirsek.

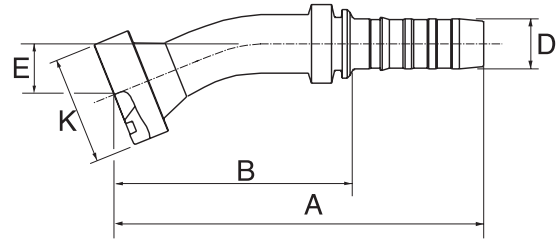

↔				↔				
D				A	B	E	K	REF.
-ölçü	DN	"		mm	mm	mm	mm	GS
-12	20	3/4	3/4"	143,0	92,0	16,0	41,3	12GS12FLC22-016
-16	25	1	1"	153,0	95,9	17,0	47,6	16GS16FLC22-017
-16	25	1	1 1/4"	153,0	95,9	17,0	54,0	16GS20FLC22-017
-20	32	1 1/4	1 1/4"	185,0	113,9	17,0	54,0	20GS20FLC22-017
-20	32	1 1/4	1 1/2"	185,0	113,9	17,0	63,5	20GS24FLC22-017
-24	40	1 1/2	1 1/2"	236,0	141,5	17,0	63,5	24GSH24FLC22-017

-12 ila -20 ölçüleri 42,0 MPa'dır (6000 psi). / Not: FLC flanşları daha kalın bir flanş başlığı ile tasarlanmıştır. 14,2 mm flanş boyutu sıklıkla Caterpillar makinelerinde bulunur. Bu flanş kullanıcının rakorlu hortumu değiştirdiğinde Caterpillar flanş keplerini kullanmasına izin verir. Kullanıcı seçeneğinde, standart Kod 62 flanşları ve kepleri Caterpillar flanşları ve kepleri yerine kullanılabilir. Standart Kod 62 flanş başlığı kalınlığı 7,8 ve 12,6 mm arasında değişir.

Aksi belirtilmedikçe Kaplin, ilgili uluslararası standardın basınç ölçüm gereksinimlerini karşılar.

FLC30

Caterpillar tipi 'O' ringli flanş. 30° dirsek.

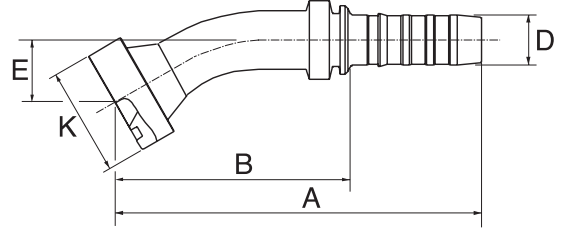

↔				↔				
D				A	B	E	K	REF.
-ölçü	DN	"		mm	mm	mm	mm	GS
-12	20	3/4	3/4"	140,0	89,0	22,0	41,3	12GS12FLC30-022
-12	20	3/4	1"	141,0	90,0	22,0	47,6	12GS16FLC30-022
-16	25	1	1"	151,0	93,7	23,0	47,6	16GS16FLC30-023
-16	25	1	1 1/4"	151,0	93,7	23,0	54,0	16GS20FLC30-023
-20	32	1 1/4	1 1/4"	183,0	111,9	24,0	54,0	20GS20FLC30-024
-20	32	1 1/4	1 1/2"	183,0	111,9	24,0	63,5	20GS24FLC30-024
-24	40	1 1/2	1 1/2"	235,0	139,5	23,0	63,5	24GSH24FLC30-023

-12 ila -20 ölçüleri 42,0 MPa'dır (6000 psi). / Not: FLC flanşları daha kalın bir flanş başlığı ile tasarlanmıştır. 14,2 mm flanş boyutu sıklıkla Caterpillar makinelerinde bulunur. Bu flanş kullanıcının rakorlu hortumu değiştirdiğinde Caterpillar flanş kepleri kullanmasına izin verir. Kullanıcı seçeneğinde, standart Kod 62 flanşları ve kepleri Caterpillar flanşları ve kepleri yerine kullanılabilir. Standart Kod 62 flanş başlığı kalınlığı 7,8 ve 12,6 mm arasında değişir.

FLC45

Caterpillar tipi 'O' ringli flanş. 45° dirsek.

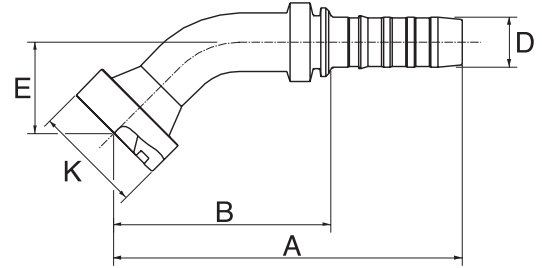

↔				↔				
D				A	B	E	K	REF.
-ölçü	DN	"		mm	mm	mm	mm	GS
-12	20	3/4	3/4"	133,0	82,0	35,0	41,3	12GS12FLC45-035
-12	20	3/4	1"	133,0	82,0	35,0	47,6	12GS16FLC45-035
-16	25	1	1"	143,0	86,3	37,0	47,6	16GS16FLC45-037
-16	25	1	1 1/4"	143,0	86,3	37,0	54,0	16GS20FLC45-037
-20	32	1 1/4	1 1/4"	176,0	104,9	37,0	54,0	20GS20FLC45-037
-20	32	1 1/4	1 1/2"	176,0	104,9	37,0	63,5	20GS24FLC45-037
-24	40	1 1/2	1 1/2"	227,0	132,0	39,0	63,5	24GSH24FLC45-039
-32	50	2	2"	287,5	173,5	64,0	79,5	32GSH32FLC45-064

-12 ila -20 ölçüleri 42,0 MPa'dır (6000 psi). / Not: FLC flanşları daha kalın bir flanş başlığı ile tasarlanmıştır. 14,2 mm flanş boyutu sıklıkla Caterpillar makinelerinde bulunur. Bu flanş kullanıcının rakorlu hortumu değiştirdiğinde Caterpillar flanş kepleri kullanmasına izin verir. Kullanıcı seçeneğinde, standart Kod 62 flanşları ve kepleri Caterpillar flanşları ve kepleri yerine kullanılabilir. Standart Kod 62 flanş başlığı kalınlığı 7,8 ve 12,6 mm arasında değişir.

Aksi belirtilmedikçe Kaplin, ilgili uluslararası standardın basınç ölçüm gereksinimlerini karşılar.

FLC60

Caterpillar tipi 'O' ringli flanş. 60° dirsek.

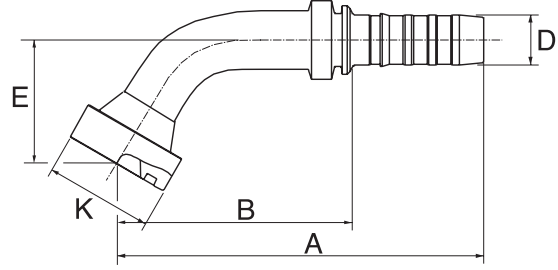

↻			↻	↻				↻
D				A	B	E	K	REF.
-ölçü	DN	"		mm	mm	mm	mm	GS
-12	20	3/4	1"	146,0	95,0	48,0	47,6	12GS16FLC60-048
-16	25	1	1"	163,0	106,0	50,0	47,6	16GS16FLC60-050
-16	25	1	1 1/4"	163,0	106,0	50,0	54,0	16GS20FLC60-050
-20	32	1 1/4	1 1/4"	198,0	126,9	52,0	54,0	20GS20FLC60-052
-20	32	1 1/4	1 1/2"	198,0	126,9	52,0	63,5	20GS24FLC60-052

-12 ila -20 ölçüleri 42,0 MPa'dır (6000 psi). / Not: FLC flanşları daha kalın bir flanş başlığı ile tasarlanmıştır. 14,2 mm flanş boyutu sıklıkla Caterpillar makinelerinde bulunur. Bu flanş kullanıcının rakorlu hortumu değiştirdiğinde Caterpillar flanş keplerini kullanmasına izin verir. Kullanıcı seçeneğinde, standart Kod 62 flanşları ve kepleri Caterpillar flanşları ve kepleri yerine kullanılabilir. Standart Kod 62 flanş başlığı kalınlığı 7,8 ve 12,6 mm arasında değişir.

FLC67

Caterpillar tipi 'O' ringli flanş. 67° dirsek.

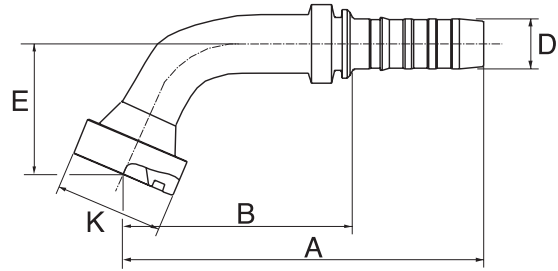

↻			↻	↻				↻
D				A	B	E	K	REF.
-ölçü	DN	"		mm	mm	mm	mm	GS
-16	25	1	1"	156,0	99,0	57,0	47,6	16GS16FLC67-057
-16	25	1	1 1/4"	156,0	99,0	57,0	54,0	16GS20FLC67-057
-20	32	1 1/4	1 1/4"	191,0	119,9	59,0	54,0	20GS20FLC67-059
-20	32	1 1/4	1 1/2"	191,0	119,9	59,0	63,5	20GS24FLC67-059

-16 ila -20 ölçüleri 42,0 MPa'dır (6000 psi). / Not: FLC flanşları daha kalın bir flanş başlığı ile tasarlanmıştır. 14,2 mm flanş boyutu sıklıkla Caterpillar makinelerinde bulunur. Bu flanş kullanıcının rakorlu hortumu değiştirdiğinde Caterpillar flanş keplerini kullanmasına izin verir. Kullanıcı seçeneğinde, standart Kod 62 flanşları ve kepleri Caterpillar flanşları ve kepleri yerine kullanılabilir. Standart Kod 62 flanş başlığı kalınlığı 7,8 ve 12,6 mm arasında değişir.

Aksi belirtilmedikçe Kaplin, ilgili uluslararası standardın basınç ölçüm gereksinimlerini karşılar.

FLC90

Caterpillar tipi 'O' ringli flanş. 90° dirsek.

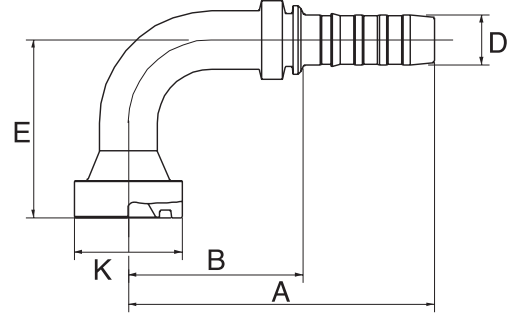

↔			⊞	↔				⊞
D				A	B	E	K	REF.
-ölçü	DN	"		mm	mm	mm	mm	GS
-12	20	3/4	3/4"	125,0	74,0	68,0	41,3	12GS12FLC90-068
-12	20	3/4	3/4"	117,0	66,0	128,0	41,3	12GS12FLC90-128
-12	20	3/4	1"	128,0	77,0	68,0	47,6	12GS16FLC90-068
-16	25	1	1"	131,0	74,1	74,0	47,6	16GS16FLC90-074
-16	25	1	1"	131,0	74,1	132,0	47,6	16GS16FLC90-132
-16	25	1	1 1/4"	131,0	74,1	74,0	54,0	16GS20FLC90-074
-20	32	1 1/4	1 1/4"	166,0	94,9	77,0	54,0	20GS20FLC90-077
-20	32	1 1/4	1 1/2"	166,0	94,9	77,0	63,5	20GS24FLC90-077
-24	40	1 1/2	1 1/2"	214,1	119,1	87,0	63,5	24GSH24FLC90-087
-32	50	2	2"	264,4	150,4	130,0	79,5	32GSH32FLC90-130

-12 ila -20 ölçüleri 42,0 MPa'dır (6000 psi). / Not: FLC flanşları daha kalın bir flanş başlığı ile tasarlanmıştır. 14,2 mm flanş boyutu sıklıkla Caterpillar makinelerinde bulunur. Bu flanş kullanıcının rakorlu hortumu değiştirdiğinde Caterpillar flanş kepleri kullanmasına izin verir. Kullanıcı seçeneğinde, standart Kod 62 flanşları ve kepleri Caterpillar flanşları ve kepleri yerine kullanılabilir. Standart Kod 62 flanş başlığı kalınlığı 7,8 ve 12,6 mm arasında değişir.

DIN 24° FDLORX

Dişi DIN 'O' ringli döner somunlu. 24° konik. Hafif seri.

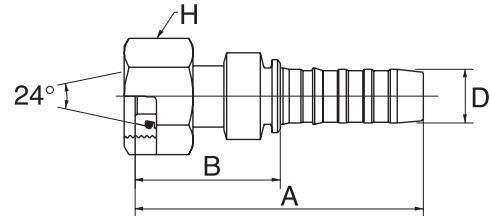

↔			⊞	↔			⊞
D				A	B	H	REF.
-ölçü	DN	"		mm	mm	mm	GS
-6	10	3/8	M18 x 1,5	73,0	37,2	22,0	6GS12FDLORX
-8	12	1/2	M22 x 1,5	73,0	35,5	27,0	8GS15FDLORX
-10	16	5/8	M26 x 1,5	91,8	41,5	32,0	10GS18FDLORX
-12	20	3/4	M30 x 2,0	97,0	46,0	36,0	12GS22FDLORX
-12	20	3/4	M36 x 2,0	99,0	48,0	41,0	12GS28FDLORX
-16	25	1	M36 x 2,0	105,0	48,6	41,0	16GS28FDLORX
-20	32	1 1/4	M45 x 2,0	132,5	61,4	50,0	20GS35FDLORX
-24	40	1 1/2	M52 x 2,0	135,7	62,0	60,0	24GS42FDLORX

-6 ila -20 ölçüleri 42,0 MPa'dır (6000 psi).

Aksi belirtilmedikçe Kaplin, ilgili uluslararası standardın basınç ölçüm gereksinimlerini karşılar.

DIN 24° FDLORX45

Dişi DIN 'O' ringli döner somunlu. 24° konik. Hafif seri. 45° dirsek. Boyun uzunluğu ISO 12151-2'yi karşılar.

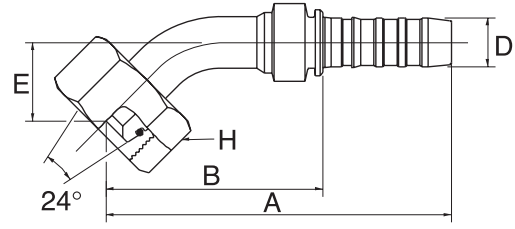

D				A B E H				REF.
-ölçü	DN	"		mm	mm	mm	mm	GS
-8	12	1/2	M22 x 1,5	94,7	57,2	20,2	27,0	8GS15FDLORX45
-12	20	3/4	M30 x 2,0	135,8	84,8	29,8	36,0	12GS22FDLORX45
-16	25	1	M36 x 2,0	155,5	99,1	30,9	41,0	16GS28FDLORX45
-24	40	1 1/2	M52 x 2,0	208,9	135,2	44,0	60,0	24GSP42FDLORX45

-8 ila -16 ölçüleri 42,0 MPa'dır (6000 psi).

DIN 24° FDLORX90

Dişi DIN 'O' ringli döner somunlu. 24° konik. Hafif seri. 90° dirsek. Boyun uzunluğu ISO 12151-2'yi karşılar.

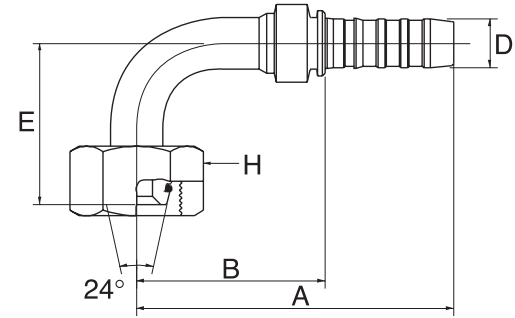

D				A B E H				REF.
-ölçü	DN	"		mm	mm	mm	mm	GS
-6	10	3/8	M18 x 1,5	78,0	42,2	37,0	22,0	6GS12FDLORX90
-8	12	1/2	M22 x 1,5	88,0	50,5	42,0	27,0	8GS15FDLORX90
-10	16	5/8	M26 x 1,5	113,5	63,2	51,5	32,0	10GS18FDLORX90
-12	20	3/4	M30 x 2,0	126,0	75,0	62,0	36,0	12GS22FDLORX90
-16	25	1	M36 x 2,0	151,0	94,6	70,0	41,0	16GS28FDLORX90
-24	40	1 1/2	M52 x 2,0	194,6	120,9	92,0	60,0	24GSP42FDLORX90

-6 ila -16 ölçüleri 42,0 MPa'dır (6000 psi).

Aksi belirtilmedikçe Kaplin, ilgili uluslararası standardın basınç ölçüm gereksinimlerini karşılar.

DIN 24° MDL

Erkek DIN paralel. 24° ters konik. Hafif seri.

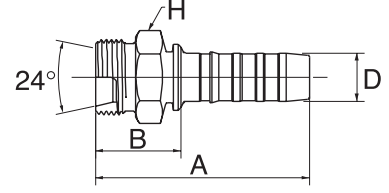

↔			🌀	↔	🌀	REF.	
D				A	B	H	REF.
-ölçü	DN	"		mm	mm	mm	GS
-6	10	3/8	M18 x 1,5	60,0	24,2	19,0	6GS12MDL
-8	12	1/2	M22 x 1,5	63,0	25,5	24,0	8GS15MDL
-10	16	5/8	M26 x 1,5	76,5	26,2	27,0	10GS18MDL
-12	20	3/4	M30 x 2,0	79,5	28,5	32,0	12GS22MDL
-16	25	1	M36 x 2,0	90,0	33,2	41,0	16GS28MDL
-24	40	1 1/2	M52 x 2,0	120,0	46,4	55,0	24GSP42MDL

-6 ila -16 ölçüleri 42,0 MPa'dır (6000 psi).

DIN 24° FDHORX

Dişi DIN 'O' ringli döner somunlu. 24° konik. Ağır seri.

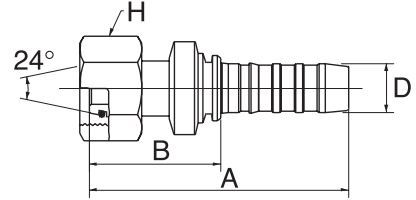

↔			🌀	↔	🌀	REF.	
D				A	B	H	REF.
-ölçü	DN	"		mm	mm	mm	GS
-6	10	3/8	M20 x 1,5	73,0	37,2	24,0	6GS12FDHORX
-6	10	3/8	M22 x 1,5	75,5	39,7	27,0	6GS14FDHORX
-8	12	1/2	M22 x 1,5	76,5	38,9	27,0	8GS14FDHORX
-8	12	1/2	M24 x 1,5	79,0	41,5	30,0	8GS16FDHORX
-8	12	1/2	M30 x 2,0	82,0	44,5	36,0	8GS20FDHORX
-10	16	5/8	M30 x 2,0	100,0	49,7	36,0	10GS20FDHORX
-10	16	5/8	M36 x 2,0	104,0	53,7	46,0	10GS25FDHORX
-12	20	3/4	M30 x 2,0	103,0	52,0	36,0	12GS20FDHORX
-12	20	3/4	M36 x 2,0	107,4	56,4	46,0	12GS25FDHORX
-12	20	3/4	M42 x 2,0	97,0	46,0	50,0	12GS30FDHORX
-16	25	1	M36 x 2,0	116,0	59,6	46,0	16GS25FDHORX
-16	25	1	M42 x 2,0	118,0	61,6	50,0	16GS30FDHORX
-20	32	1 1/4	M52 x 2,0	145,0	73,9	60,0	20GS38FDHORX
-24	40	1 1/2	M52 x 2,0	180,0	85,0	60,0	24GSH38FDHORX
-24	40	1 1/2	M52 x 2,0	150,0	76,3	60,0	24GSP38FDHORX

-6 ila -20 ölçüleri 42,0 MPa'dır (6000 psi).

Aksi belirtilmedikçe Kaplin, ilgili uluslararası standardın basınç ölçüm gereksinimlerini karşılar.

DIN 24° FDHORX45

Dişi DIN 'O' ringli döner somunlu. 24° konik. Ağır seri. 45° dirsek. Boyun uzunluğu ISO 12151-2'yi karşılar.

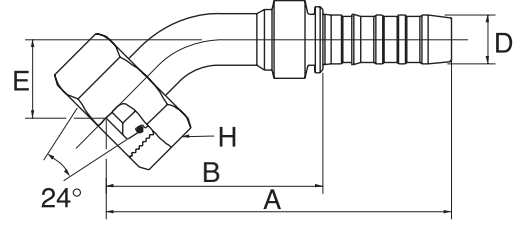

D				A B E H				
-ölçü	DN	"		mm	mm	mm	mm	REF. GS
-6	10	3/8	M20 x 1,5	86,7	50,8	18,9	24,0	6GS12FDHORX45
-6	10	3/8	M22 x 1,5	88,8	53,0	21,0	27,0	6GS14FDHORX45
-8	12	1/2	M24 x 1,5	96,1	58,7	21,6	30,0	8GS16FDHORX45
-10	16	5/8	M30 x 2,0	121,6	71,3	24,9	36,0	10GS20FDHORX45
-12	20	3/4	M30 x 2,0	160,9	109,9	29,8	36,0	12GS20FDHORX45
-12	20	3/4	M36 x 2,0	137,3	86,3	31,2	46,0	12GS25FDHORX45
-16	25	1	M36 x 2,0	159,7	103,3	35,1	46,0	16GS25FDHORX45
-16	25	1	M42 x 2,0	159,7	103,3	35,1	50,0	16GS30FDHORX45
-20	32	1 1/4	M52 x 2,0	196,0	124,9	42,5	60,0	20GS38FDHORX45
-24	40	1 1/2	M52 x 2,0	236,9	141,9	44,0	60,0	24GSH38FDHORX45
-24	40	1 1/2	M52 x 2,0	208,9	135,2	44,0	60,0	24GSP38FDHORX45

-6 ila -20 ölçüleri 42,0 MPa'dır (6000 psi).

DIN 24° FDHORX90

Dişi DIN 'O' ringli döner somunlu. 24° konik. Ağır seri. 90° dirsek. Boyun uzunluğu ISO 12151-2'yi karşılar.

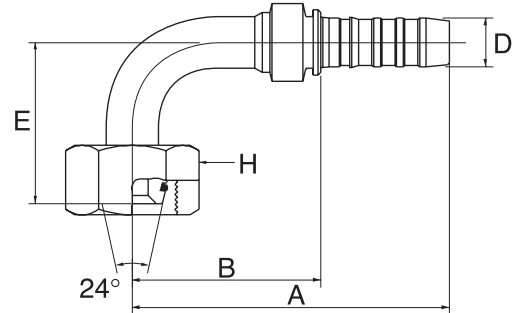

D				A B E H				
-ölçü	DN	"		mm	mm	mm	mm	REF. GS
-6	10	3/8	M20 x 1,5	78,0	42,2	37,0	24,0	6GS12FDHORX90
-6	10	3/8	M22 x 1,5	78,0	42,2	40,0	27,0	6GS14FDHORX90
-8	12	1/2	M24 x 1,5	88,0	50,5	44,0	30,0	8GS16FDHORX90
-10	16	5/8	M30 x 2,0	112,5	62,2	51,0	36,0	10GS20FDHORX90
-12	20	3/4	M30 x 2,0	126,0	75,0	62,0	36,0	12GS20FDHORX90
-12	20	3/4	M36 x 2,0	126,0	75,0	64,0	46,0	12GS25FDHORX90
-16	25	1	M36 x 2,0	151,0	94,6	76,0	46,0	16GS25FDHORX90
-16	25	1	M42 x 2,0	151,0	94,6	76,0	50,0	16GS30FDHORX90
-20	32	1 1/4	M52 x 2,0	180,5	109,4	87,0	60,0	20GS38FDHORX90
-24	40	1 1/2	M52 x 2,0	222,6	127,6	92,0	60,0	24GSH38FDHORX90
-24	40	1 1/2	M52 x 2,0	194,6	121,0	92,0	60,0	24GSP38FDHORX90

-6 ila -20 ölçüleri 42,0 MPa'dır (6000 psi).

Aksi belirtilmedikçe Kaplin, ilgili uluslararası standardın basınç ölçüm gereksinimlerini karşılar.

DIN 24° MDH

Erkek DIN paralel. 24° ters konik. Ağır seri.

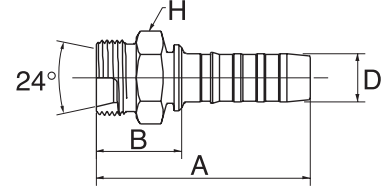

↔			🌀	↔			🌀
D				A	B	H	REF.
-ölçü	DN	"		mm	mm	mm	GS
-6	10	3/8	M20 x 1,5	63,7	27,9	22,0	6GS12MDH
-6	10	3/8	M22 x 1,5	65,7	29,9	24,0	6GS14MDH
-8	12	1/2	M24 x 1,5	67,5	30,0	27,0	8GS16MDH
-10	16	5/8	M30 x 2,0	85,0	34,7	32,0	10GS20MDH
-12	20	3/4	M30 x 2,0	85,0	34,0	32,0	12GS20MDH
-12	20	3/4	M36 x 2,0	89,0	38,0	41,0	12GS25MDH
-12	20	3/4	M42 x 2,0	95,0	44,0	46,0	12GS30MDH
-16	25	1	M36 x 2,0	97,0	40,2	41,0	16GS25MDH
-16	25	1	M42 x 2,0	99,0	42,2	46,0	16GS30MDH
-20	32	1 1/4	M52 x 2,0	123,0	51,9	55,0	20GS38MDH

-6 ila -20 ölçüleri 42,0 MPa'dır (6000 psi).

NPTF MP

Erkek NPTF boru.

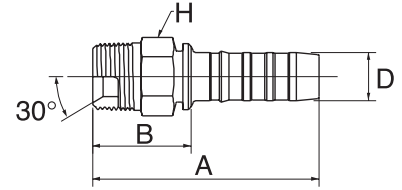

↔			🌀	↔			🌀
D				A	B	H	REF.
-ölçü	DN	"		mm	mm	mm	GS
-6	10	3/8	3/8" - 18 NPTF	69,0	33,2	17,5	6GS6MP
-6	10	3/8	1/2" - 14 NPTF	73,0	37,2	22,2	6GS8MP
-8	12	1/2	1/2" - 14 NPTF	74,0	36,5	22,2	8GS8MP
-8	12	1/2	3/4" - 14 NPTF	77,0	39,5	27,0	8GS12MP
-10	16	5/8	1/2" - 14 NPTF	87,0	36,7	23,8	10GS8MP
-10	16	5/8	3/4" - 14 NPTF	91,0	40,7	28,6	10GS12MP
-12	20	3/4	3/4" - 14 NPTF	90,0	39,0	27,0	12GS12MP
-12	20	3/4	1" - 11,5 NPTF	97,0	46,0	34,9	12GS16MP
-16	25	1	3/4" - 14 NPTF	101,0	44,2	34,9	16GS12MP
-16	25	1	1" - 11,5 NPTF	106,0	49,2	34,9	16GS16MP
-16	25	1	1 1/4" - 11,5 NPTF	109,0	52,2	44,5	16GS20MP
-20	32	1 1/4	1 1/4" - 11,5 NPTF	127,0	55,9	44,5	20GS20MP
-24	40	1 1/2	1 1/2" - 11,5 NPTF	133,0	59,4	50,8	24GSP24MP
-32	50	2	2" - 11,5 NPTF	191,6	77,6	69,9	32GSH32MP
-32	50	2	2" - 11,5 NPTF	153,7	61,7	63,5	32GSP32MP

-6 ila -20 ölçüleri 42,0 MPa'dır (6000 psi). / (W) Uyarı: Sadece NPTF bağlantıları için kullanın. Petrol sahası (API) bağlantılarında kullanmayın. Bir petrol sahası bağlantısı kaçacağı ciddi yaralanmalara neden olabilir.

Aksi belirtilmedikçe Kaplin, ilgili uluslararası standardın basınç ölçüm gereksinimlerini karşılar.

UNF MB

Erkek SAE 'O' ring boss. SAE J1926/2.
ISO 11926/2 ağır hizmet (S serisi).

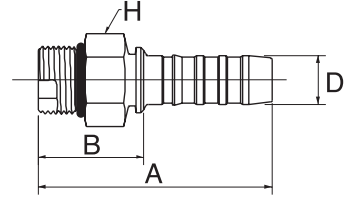

D				A B H			REF.
-ölçü	DN	"		mm	mm	mm	
-6	10	3/8	9/16" - 18 UNF	65,0	29,2	17,5	6GS6MB
-8	12	1/2	3/4" - 16 UNF	70,0	32,6	22,2	8GS8MB
-8	12	1/2	7/8" - 14 UNF	72,0	34,5	25,4	8GS10MB
-10	16	5/8	7/8" - 14 UNF	88,0	37,7	25,4	10GS10MB
-10	16	5/8	1 1/16" - 12 UN	88,0	37,7	31,8	10GS12MB
-12	20	3/4	1 1/16" - 12 UN	93,0	42,0	31,8	12GS12MB
-12	20	3/4	1 5/16" - 12 UN	90,0	39,0	38,1	12GS16MB
-16	25	1	1 5/16" - 12 UN	98,0	41,2	38,1	16GS16MB
-20	32	1 1/4	1 5/8" - 12 UN	115,0	43,9	47,6	20GS20MB

-6 ila -20 ölçüleri 42,0 MPa'dır (6000 psi).

FG FFGX

Dişi French Gaz döner somunlu. 24° konik.

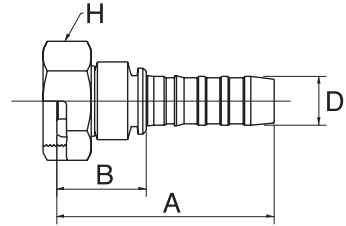

D				A B H			REF.
-ölçü	DN	"		mm	mm	mm	
-8	12	1/2	M24 x 1,5	68,0	30,5	30,0	8GS17FFGX
-10	16	5/8	M30 x 1,5	82,5	32,2	36,0	10GS21FFGX
-12	20	3/4	M36 x 1,5	87,5	36,5	41,0	12GS27FFGX
-16	25	1	M45 x 1,5	95,5	39,1	55,0	16GS34FFGX

-8 ila -16 ölçüleri 35,0 MPa'dır (5000 psi).

Aksi belirtilmedikçe Kaplin, ilgili uluslararası standardın basınç ölçüm gereksinimlerini karşılar.

FG FFGX90

Dişi French Gaz döner somunlu. 24° konik. 90° dirsek.

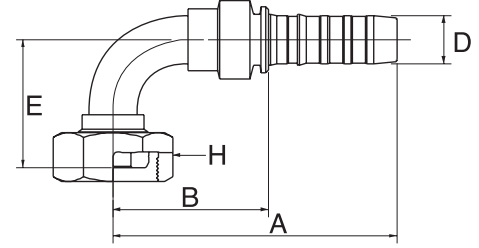

D				A B E H				REF.
-ölçü	DN	"		mm	mm	mm	mm	GS
-8	12	1/2	M24 x 1,5	76,1	38,7	37,8	30,0	8GS17FFGX90
-10	16	5/8	M30 x 1,5	92,0	41,7	45,0	36,0	10GS21FFGX90

-8 ila -10 ölçüleri 35,0 MPa'dır (5000 psi).

FG MFG

Erkek French Gaz paralel. 24° ters konik.

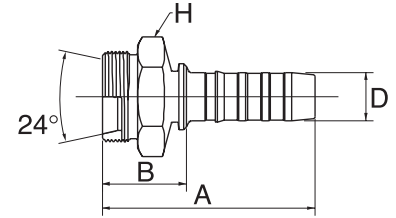

D				A B H			REF.
-ölçü	DN	"		mm	mm	mm	GS
-8	12	1/2	M24 x 1,5	66,5	29,0	27,0	8GS17MFG
-10	16	5/8	M30 x 1,5	82,0	31,7	32,0	10GS21MFG
-12	20	3/4	M36 x 1,5	84,5	33,5	41,0	12GS27MFG
-16	25	1	M45 x 1,5	94,0	37,2	46,0	16GS34MFG

-8 ila -16 ölçüleri 35,0 MPa'dır (5000 psi).

FG FPFL

Dişi yüksek basınçlı French Gaz flanş. 24° Poclain ters konik.

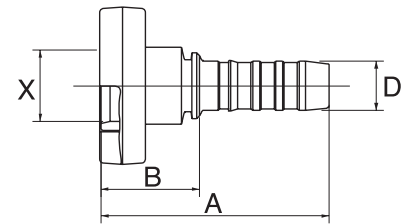

D			X	A B		REF.
-ölçü	DN	"	mm	mm	mm	GS
-8	12	1/2	17,0	69,0	31,5	8GS17FPFL
-10	16	5/8	21,0	85,0	34,7	10GS21FPFL
-12	20	3/4	27,0	91,0	40,0	12GS27FPFL
-16	25	1	34,0	102,0	45,2	16GS34FPFL
-20	32	1 1/4	42,0	133,0	61,9	20GS42FPFL

-8 ila -20 ölçüleri 35,0 MPa'dır (5000 psi).

Aksi belirtilmedikçe Kaplin, ilgili uluslararası standardın basınç ölçüm gereksinimlerini karşılar.

FG MPFL

Erkek yüksek basınçlı French Gaz flanş.
24° Poclairn ters konik.

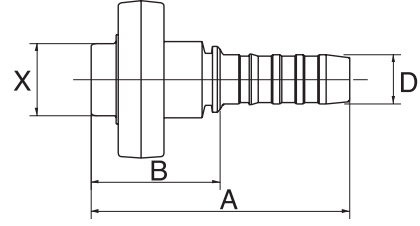

↔			↔			↔
D			X	A	B	REF.
-ölçü	DN	"	mm	mm	mm	GS
-8	12	1/2	17,0	79,0	41,5	8GS17MPFL
-10	16	5/8	21,0	95,0	44,7	10GS21MPFL
-12	20	3/4	27,0	102,0	51,0	12GS27MPFL
-16	25	1	34,0	116,0	59,2	16GS34MPFL
-20	32	1 1/4	42,0	172,0	100,9	20GS42MPFL

-8 ila -20 ölçüleri 35,0 MPa'dır (5000 psi).

FG MPFL90

Erkek yüksek basınçlı French Gaz flanş.
24° Poclairn ters konik. 90° dirsek.

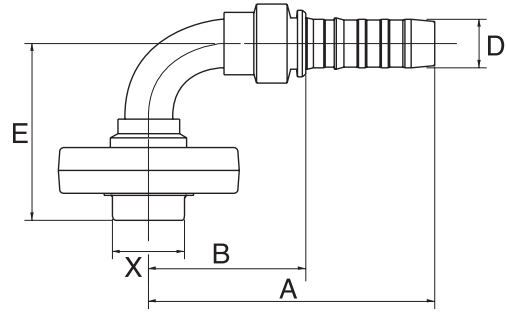

↔			↔			↔	
D			X	A	B	E	REF.
-ölçü	DN	"	mm	mm	mm	mm	GS
-10	16	5/8	21,0	92,0	41,7	57,8	10GS21MPFL90
-12	20	3/4	27,0	100,3	49,3	68,8	12GS27MPFL90
-16	25	1	34,0	126,3	69,5	89,3	16GS34MPFL90
-20	32	1 1/4	42,0	149,9	78,7	89,4	20GS42MPFL90

-10 ila -20 ölçüleri 35,0 MPa'dır (5000 psi).

Aksi belirtilmedikçe Kaplin, ilgili uluslararası standardın basınç ölçüm gereksinimlerini karşılar.

KOBELCO MKB

Erkek Kobelco tipi.

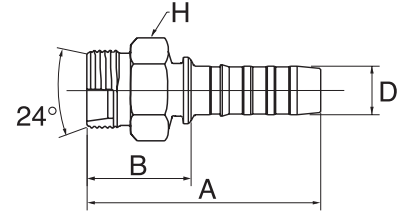

↔			🌀	↔			🌀
D				A	B	H	REF.
-ölçü	DN	"		mm	mm	mm	GS
-12	20	3/4	M30 x 1,5	85,0	34,0	36,0	12GS22MKB
-12	20	3/4	M36 x 1,5	92,0	41,0	41,0	12GS28MKB
-16	25	1	M36 x 1,5	101,0	44,2	50,0	16GS28MKB
-16	25	1	M45 x 1,5	95,0	38,2	50,0	16GS35MKB

HORTUM UZUNLUĞU ARTTIRICI

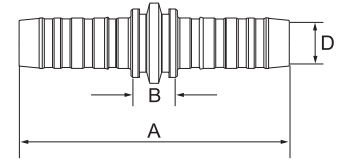

↔			↔		🌀
D			A	B	REF.
-ölçü	DN	"	mm	mm	GS
-8	12	1/2	94,0	19,1	8GS8HLE
-12	20	3/4	163,0	61,0	12GS12HLE
-16	25	1	180,0	66,4	16GS16HLE
-20	32	1 1/4	172,0	29,8	20GS20HLE

Aksi belirtilmedikçe Kaplin, ilgili uluslararası standardın basınç ölçüm gereksinimlerini karşılar.

HORTUM UZUNLUĐU ARTTIRICI 90

90° dirsek.

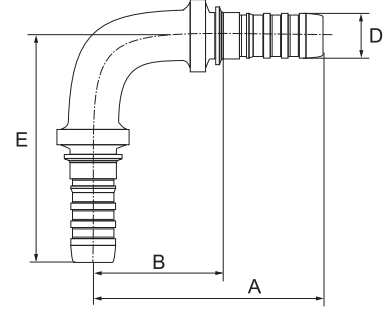

↔			↔			↔
D			A	B	E	REF.
-ölçü	DN	"	mm	mm	mm	GS
-8	12	1/2	86,0	48,5	86,0	8GS8HLE90-086
-12	20	3/4	128,8	77,8	128,8	12GS12HLE90-129
-16	25	1	127,0	70,2	127,0	16GS16HLE90-127
-20	32	1 1/4	155,0	83,9	155,0	20GS20HLE90-155

Aksi belirtilmedikçe Kaplin, ilgili uluslararası standardın basınç ölçüm gereksinimlerini karşılar.